

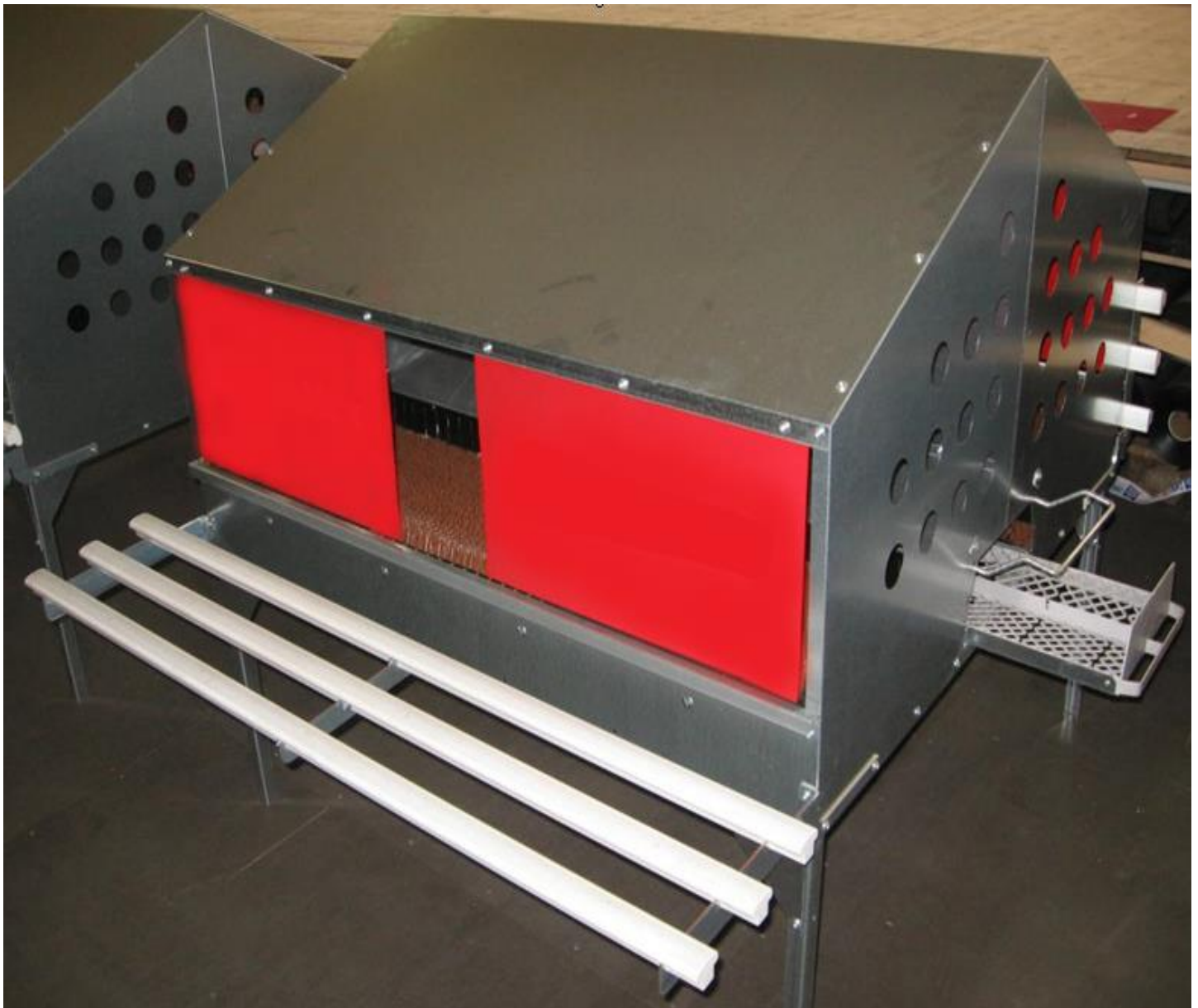

# SMART NEST

## ASSEMBLY MANUAL



# **Assembly instructions for SMART laying nest with drawer**

## **1.1 Preparing the drawer**

Insert the right and left on the drawer (1306-0630) the angle of the drawer (4125-8585) too. Put a washer on each hole (2162-1035) and rivet everything with 4 rivets (2170-0010) per side.

## **1.2 Preparing the drawer**

Fix the stop (4125-8590) with 3 screws (2117-0001) and nuts (2143-0015) to the bottom and the end piece.

## **1.3 Preparing the drawer**

Fix the screws (2109-0052) with 2 nuts each (2143-0015) to the stop. Later, once the nest is complete, they shall be exactly adjusted.

## **2.1 Preparing the egg-channel cover**

Place the fringes for the manual nest (4325-0100) onto the egg-channel cover (4125-4680) and pop-rivet them from inside out with rivets (2170-0005).

## **3.1 Preparing the stands**

Lay the stand 1 (4125-3945) and 2 (4125-3955) into each other. Place the screw (2119-0027) through the holes and put 2 nuts each (2140-0020) between the legs of the stand no. 2. Put a self-locking nut (2142-0015) from the outside onto the screw.

## **4.1 Assembly of base frame**

Lay the side rails (4125-4065) onto the prepared cross members from 4.2. together with the gussets (4125-3950). Bolt all together in the corner with the screw (2119-0007). Secure the screws additionally with a lock nut (2143-0005).

## **4.2 Assembly of base frame**

Now, affix the gussets with screw (2117-0001) and nut (2143-0015). Screw additionally each 4 screws (2109-0050) with nuts (2143-0015) into the side rails.

## **4.3 Assembly of base frame**

Fix the support for the drawer (4125-4850) under the angle rail manual nest (4125-3970) with Pop rivets (2170-0010).

## **4.4 Assembly of base frame**

Place the 2 angle rails from 5.3 onto the base frame and bolt them together with lens-head screws (2117-0001).

## **4.5 Assembly of base frame**

Place the prepared drawer (5504-2625) from 1.3 onto the base frame.  
**(For further assembly, the drawer is blanked out in the pictures).**

## **5.1 Assembly of upper part**

Fix 1 left gable (4125-8570) and 1 right gable (4125-8575) to one end of the nest. At this stage

tighten only the inner 2 screws (2117-0001), without nuts.

### **5.2 Assembly of upper part**

Screw the left (4125-3925) and the right (4125-3965) support for the bracket with 2 screws each (2117-0001) to the end of the nest.

Bolt the supports to the side rails and only for these screws use self-locking nuts (2143-0015).

### **5.3 Assembly of upper part**

Stick the tabs of the pre-assembled egg-channel cover (5504-1140) from 2.1 through the slots in the gable-walls and bend them upwards towards the hole.

### **5.4 Assembly of upper part**

Fix the tabs to the gable with 1 screw (2117-0001) and 1 self-locking nut each (2143-0015).

### **5.5 Assembly of upper part**

At the other end of the nest fix the gables as described under 5.1. Watch out to stick the tabs (as in 6.3) through the slots in the gable and fix the tabs as described in 5.4

### **5.6 Assembly of upper part**

Fix the 2 supports for the bracket (left and right), as shown in 5.2.

### **5.7 Assembly of upper part**

Place the back wall (4125-4070) between the gables.

### **5.8 Assembly of upper part**

Bolt the back wall together with the gables and the egg-channel cover with 12 screws (2117-0001) and nuts (2143-0015). Fix nuts only hand-tight!

### **6.1 Install nest bottom**

Slide on every Astroturf mat (1305-0005) 2 mat-holders each (1306-0045).

### **6.2 Install nest bottom**

Place 3 Astroturf-holders (1306-0040) onto the supporting mesh (4124-0220) as shown.

### **6.3 Install nest bottom**

Clip the prepared mat onto the supporting mesh.

### **6.4 Install nest bottom**

Place the prepared nest bottom into the nest. At the backside it lies on the base frame as in 4.4; at the front on the screws of 4.2.

### **7.1 Roof assembly**

Screw the lens-head screws (2117-0001) from outside into the holes of the front edge of the roof (4125-8580).

### **7.2 Roof assembly**

Place the canvas (4325-0040) on the inside with the holes onto the screws. Put a lock nut (2143-0015) on each screw.

### **7.3 Roof assembly**

Place the 2 roof-halves onto the gable. Watch out to have the back wall between the edges of the roof-halves (4125-8580).

### **7.4 Roof assembly**

Screw the roof-halves to the ridge. (The canvas is blanked out in the picture).

### **7.5 Roof assembly**

Screw the roof-halves to the gables. Lastly, screw the side rail to the gables.

Align the roof and the gables.

Now tighten all screws from 5.8; 7.4; 7.5

### **8.1 Assembly of landing perch**

Screw the brackets of the landing perch (4125-8185) to the supports.

Tighten the nuts (2142-0010) only so far that it is still possible to move the brackets.

### **8.2 Assembly of landing perch**

Slide the stiffening plate (4125-8195) in the perch (4325-0240) and plug both ends with an end cap (2308-0930).

### **8.3 Assembly of landing perch**

Insert the prepared perches from 10.2 centered on the boom. In addition, the agent support (4125-8190) is centered under the perches. Screw all perches with 3 self-drilling screws (2105-0011).

### **9.1 Mounting Egg Saver**

On the side of the nest, where the handle of the drawer is, insert the loose ends from Egg Saver (4125-8710) through the top two holes in the gables. Slide the Egg Saver through to the other gable and there through the bottom holes.

### **9.2 Mounting Egg Saver**

Secure the loose ends with a lock washer (2166-0005)

## 1.1

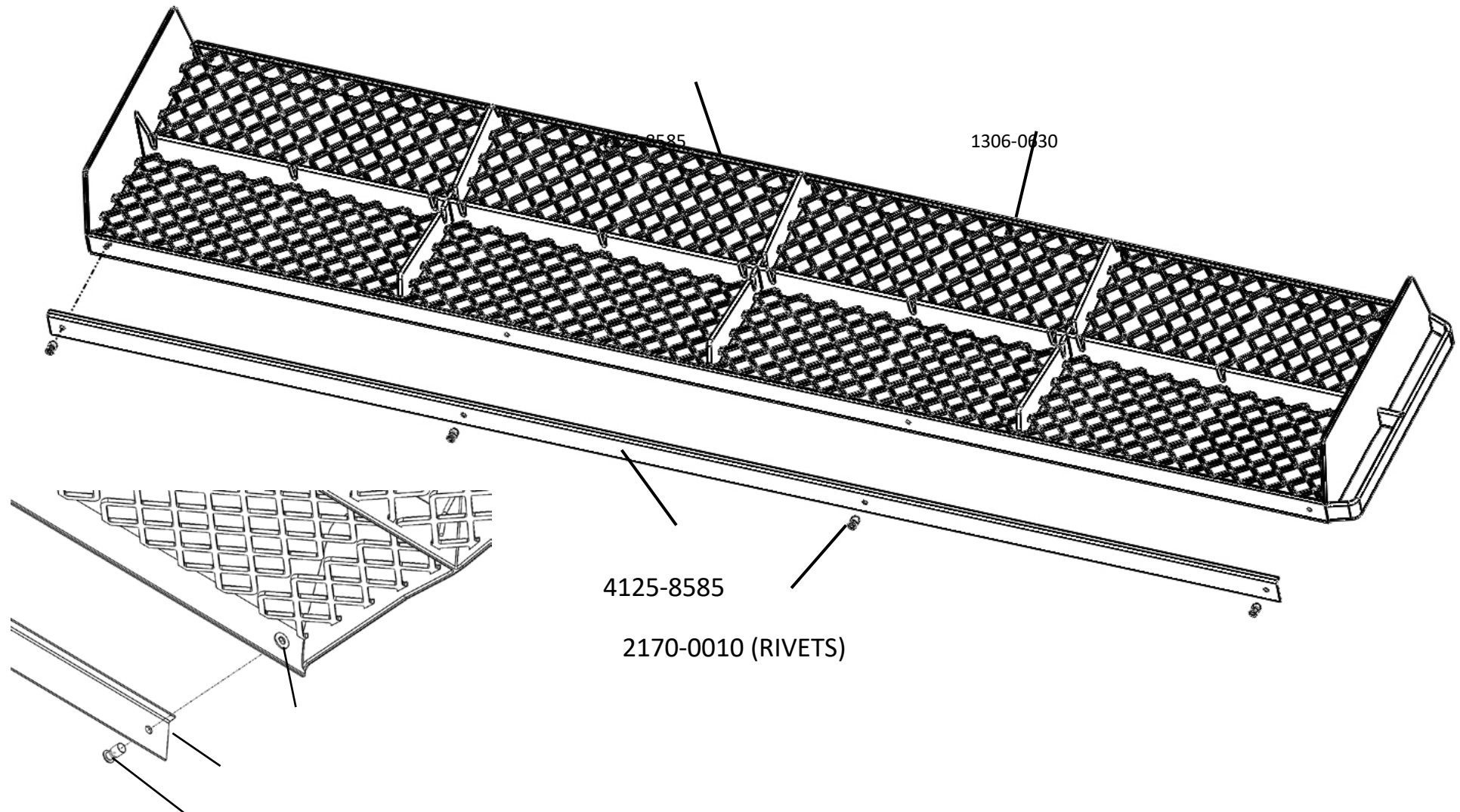

## 1.2

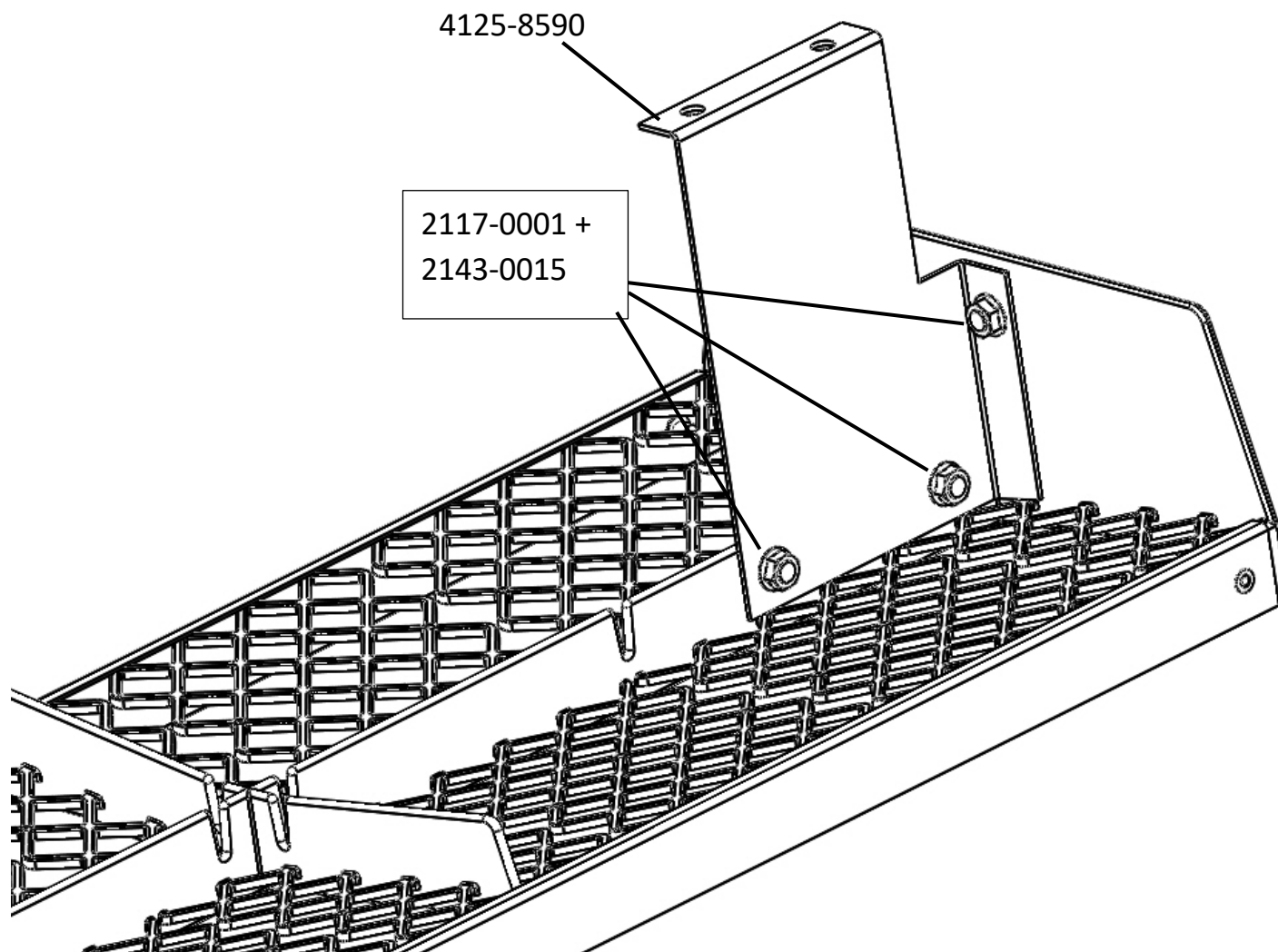



## 1.3

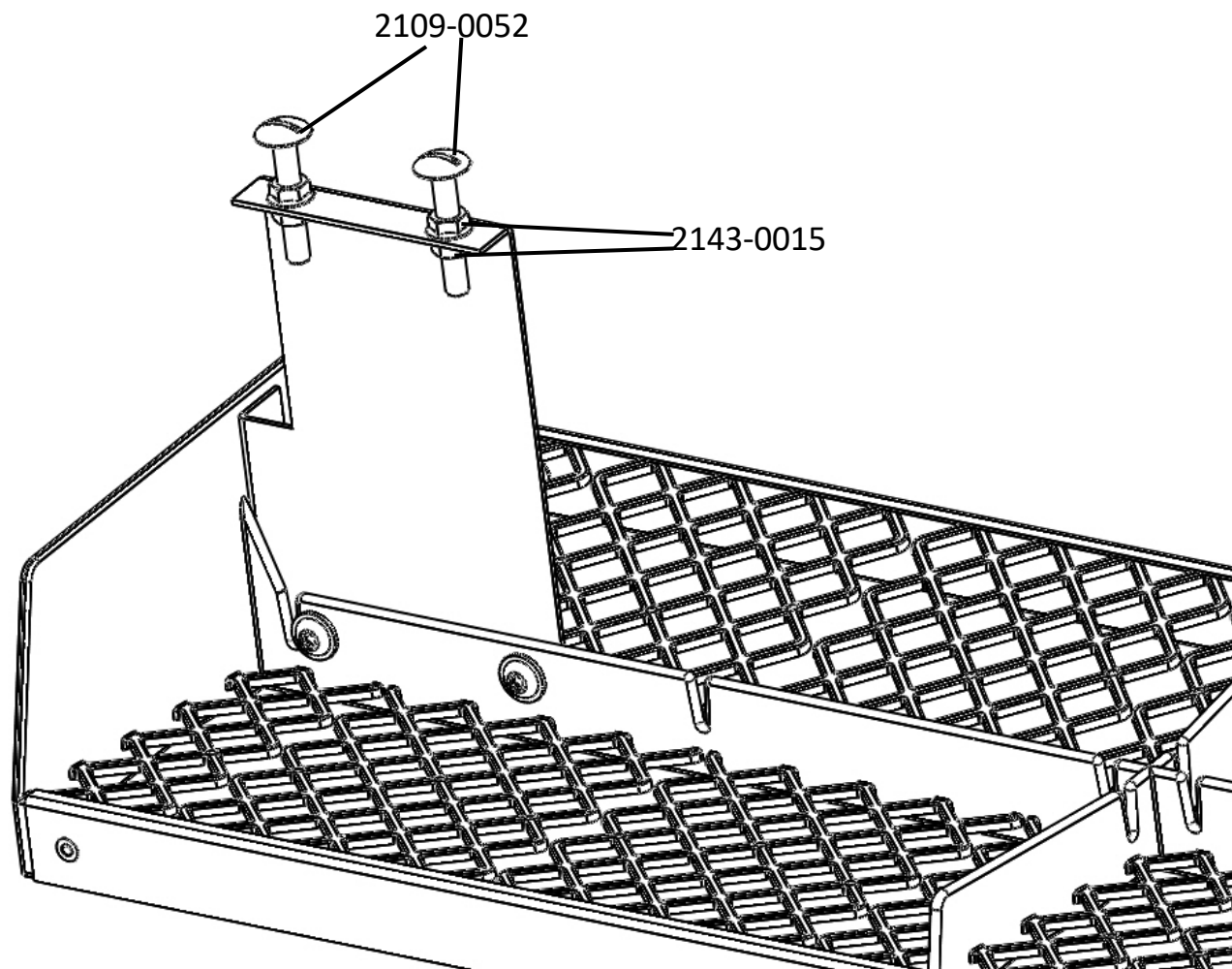

## 2.1

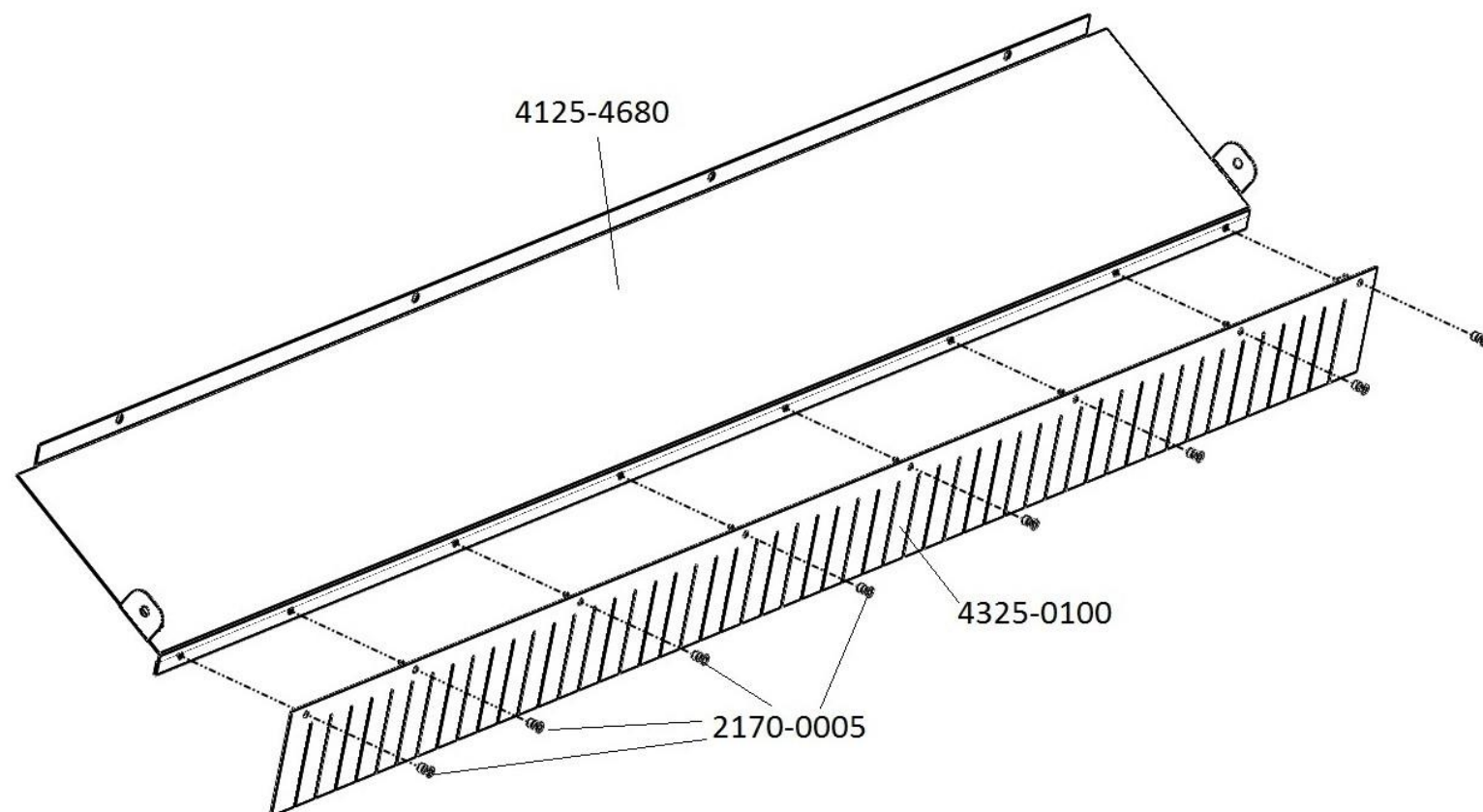



## 3.1

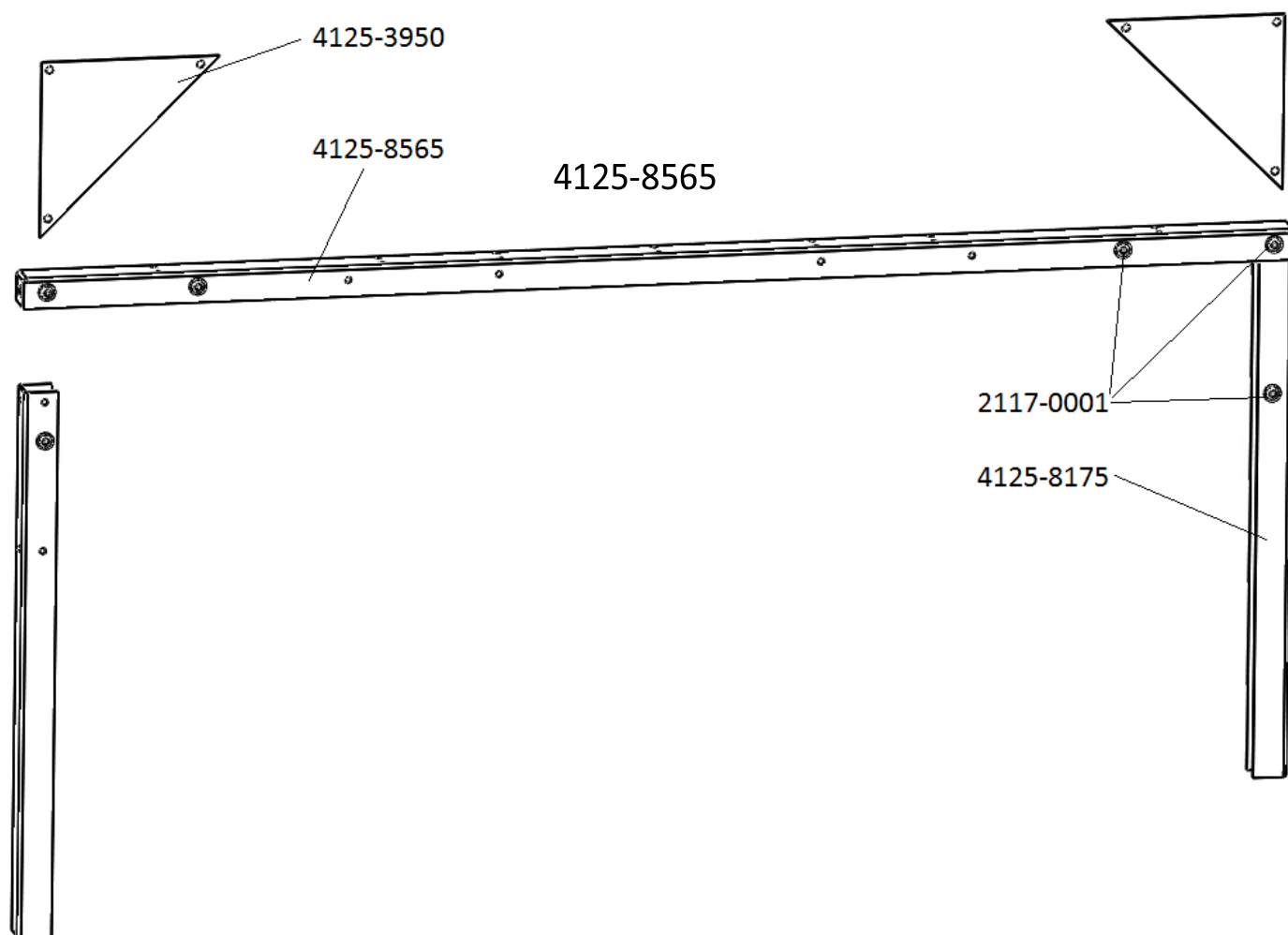

## 4.1

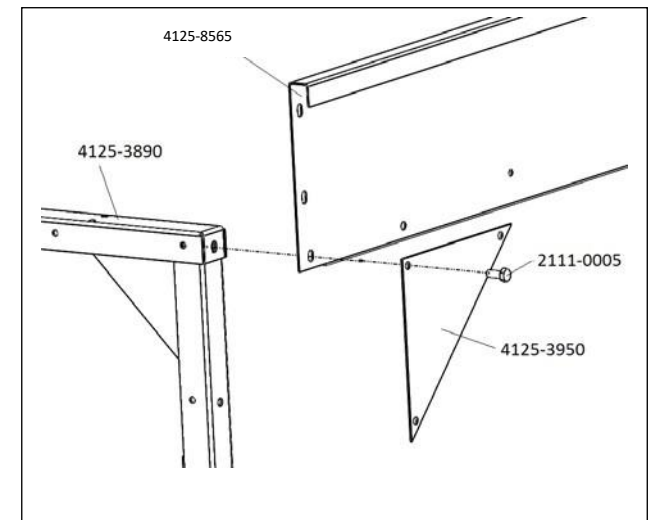
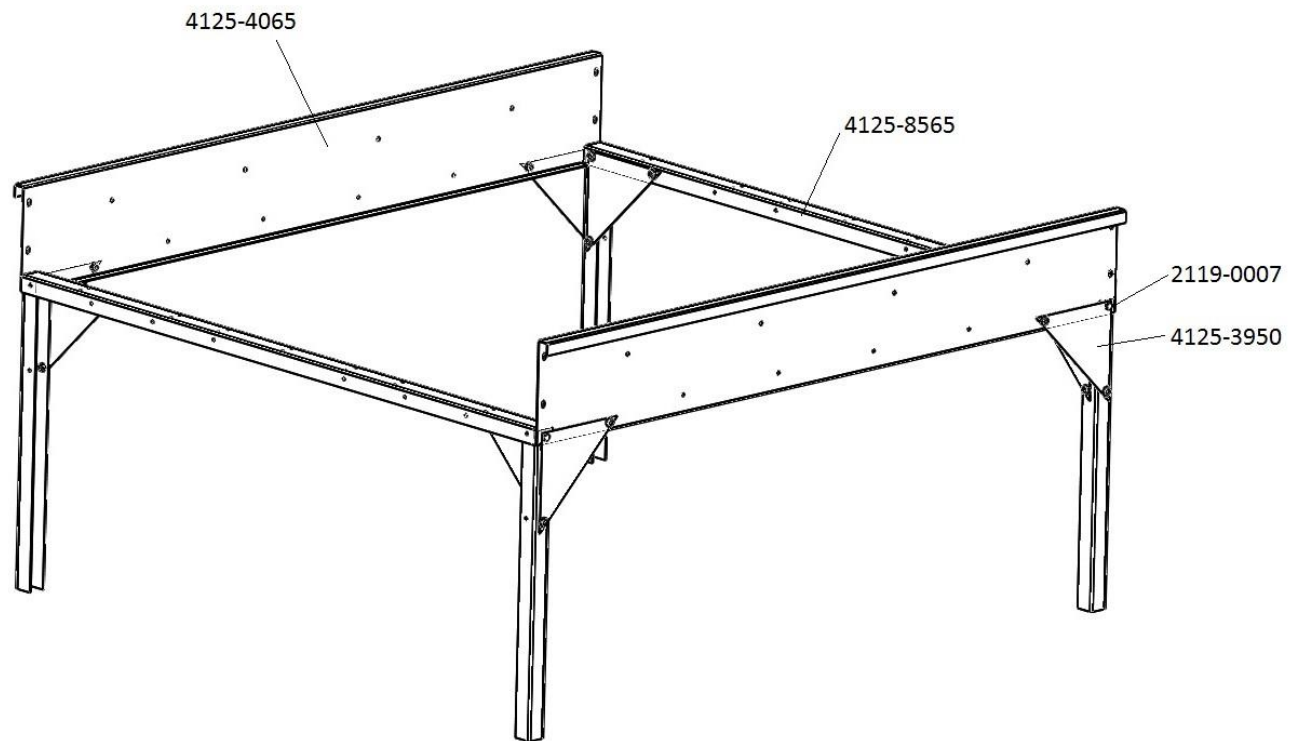

## 4.2

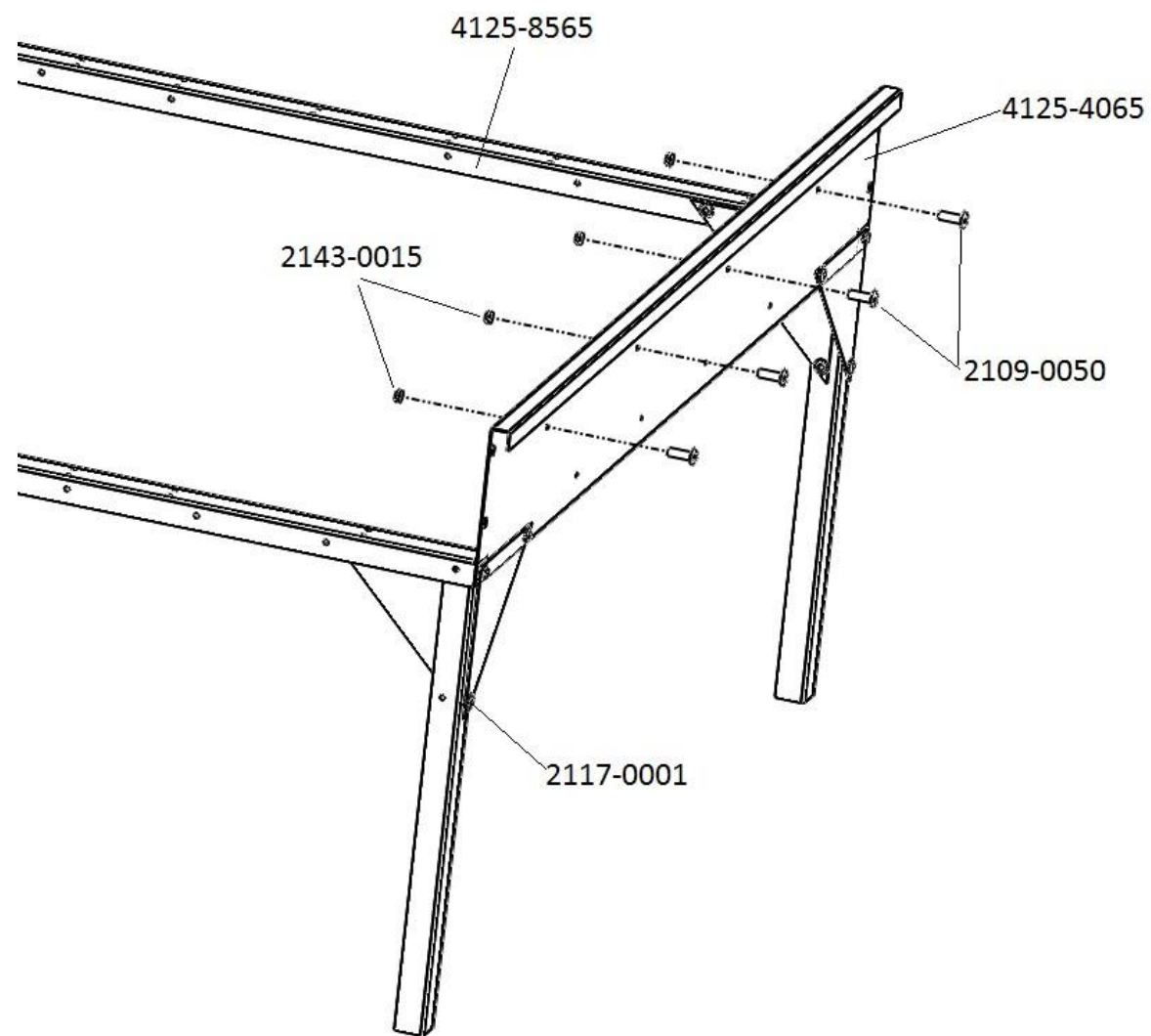

## 4.3

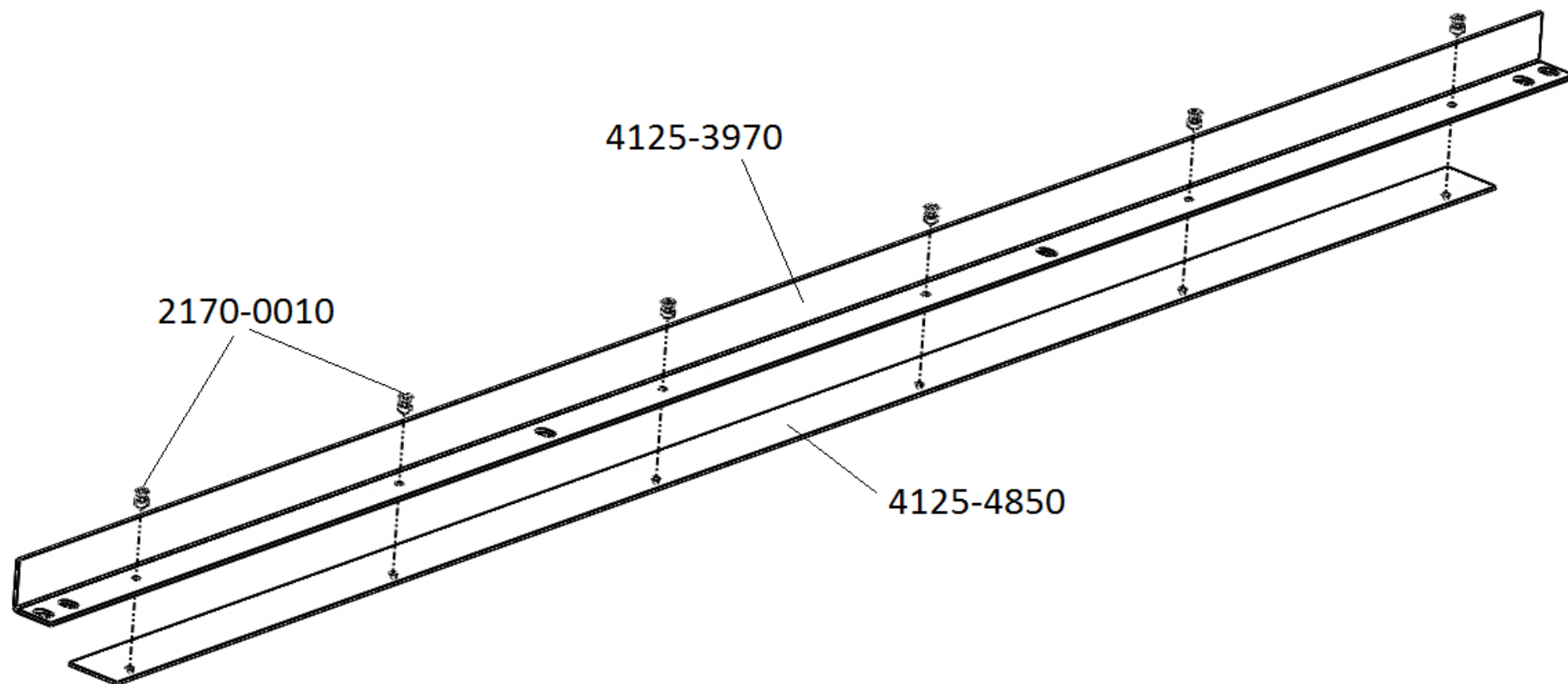

## 4.4

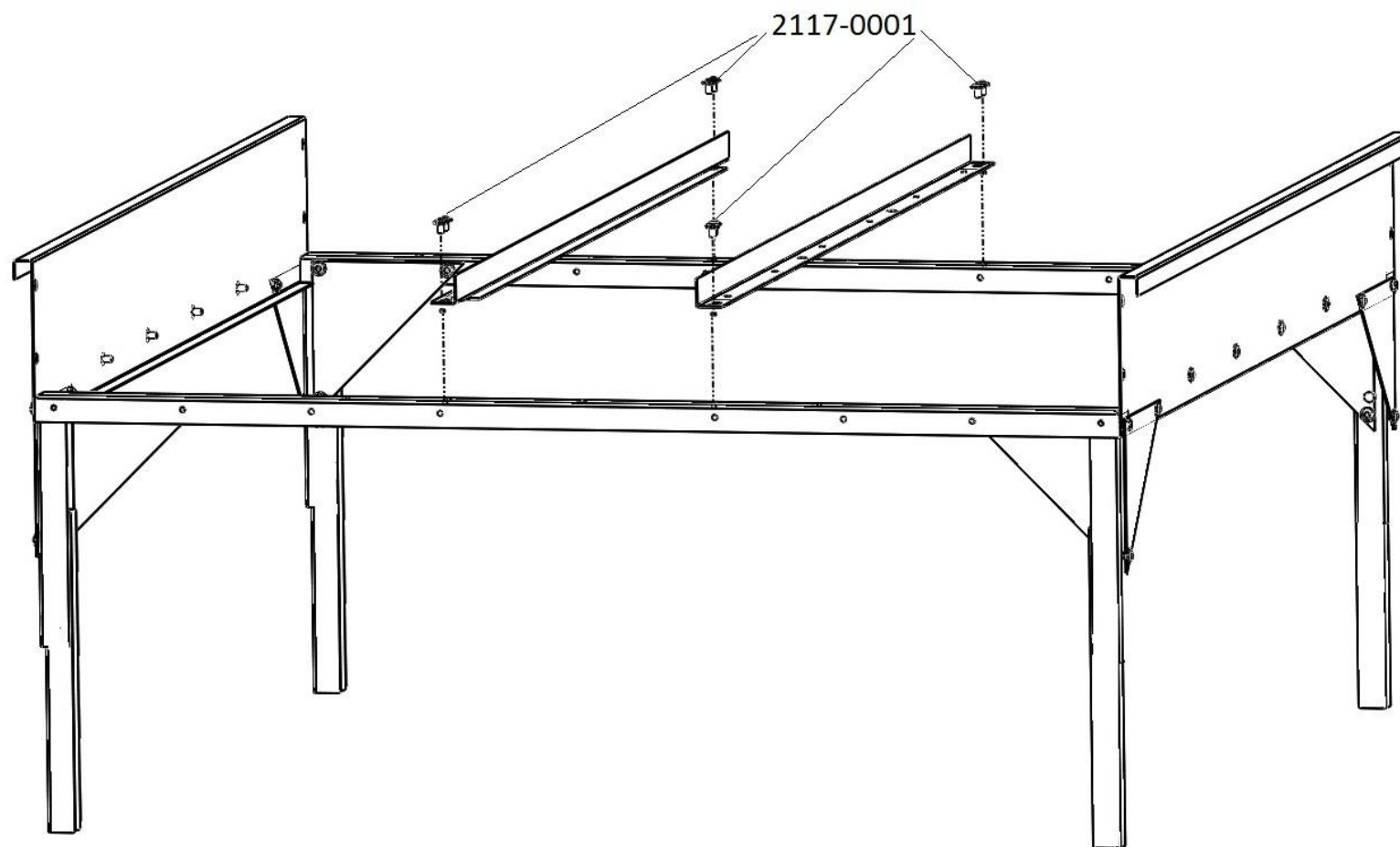

4.5

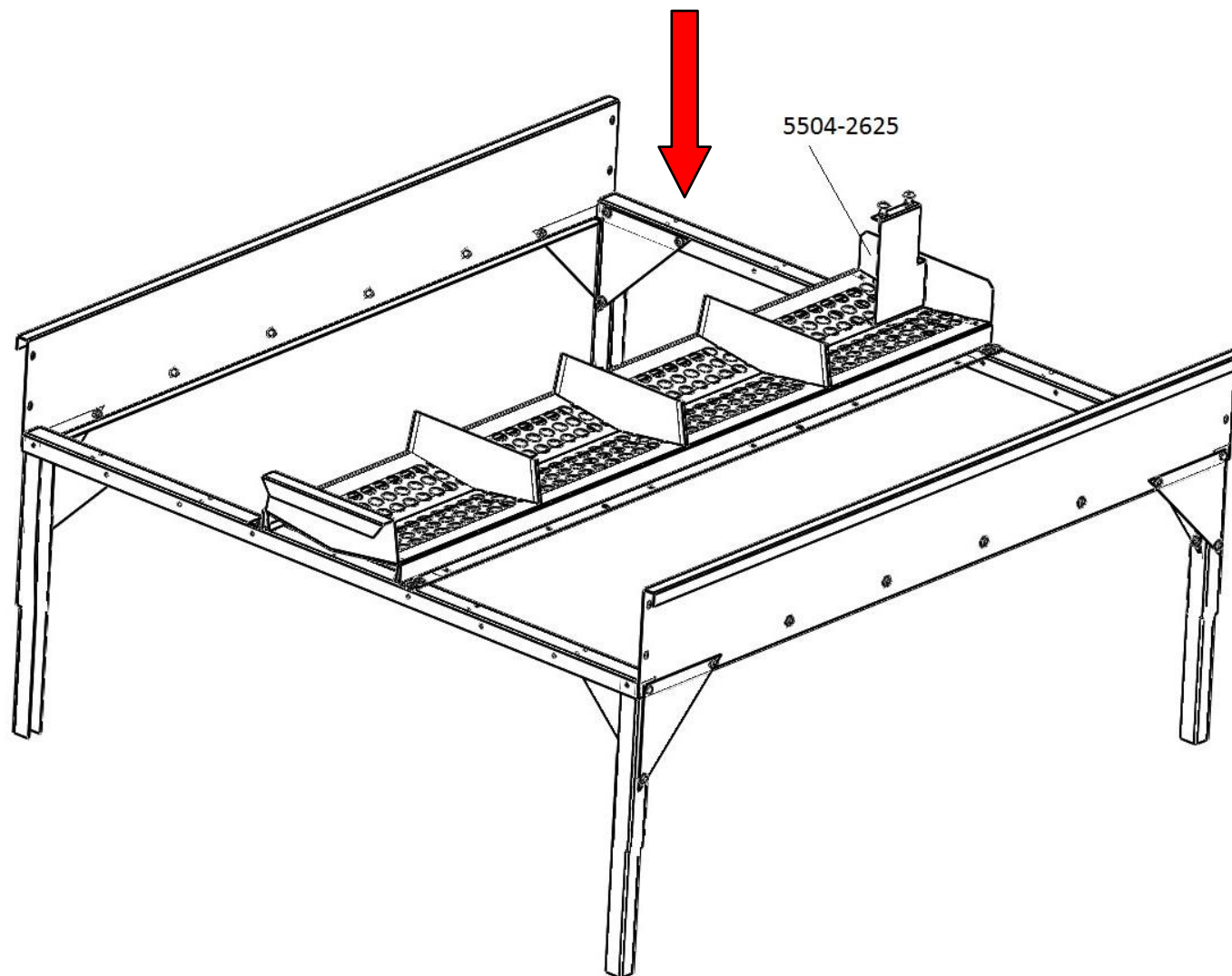



## 5.1

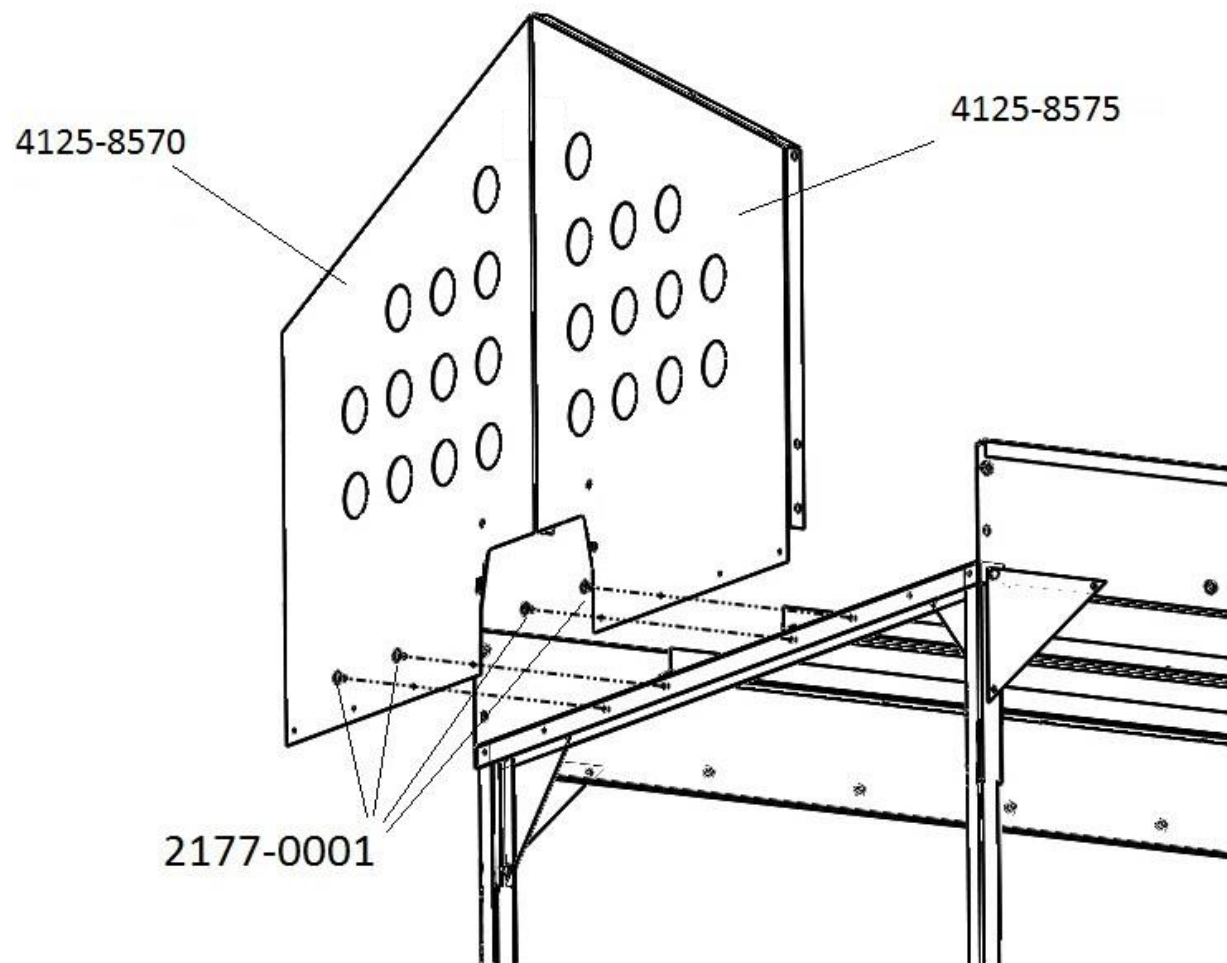

## 5.2

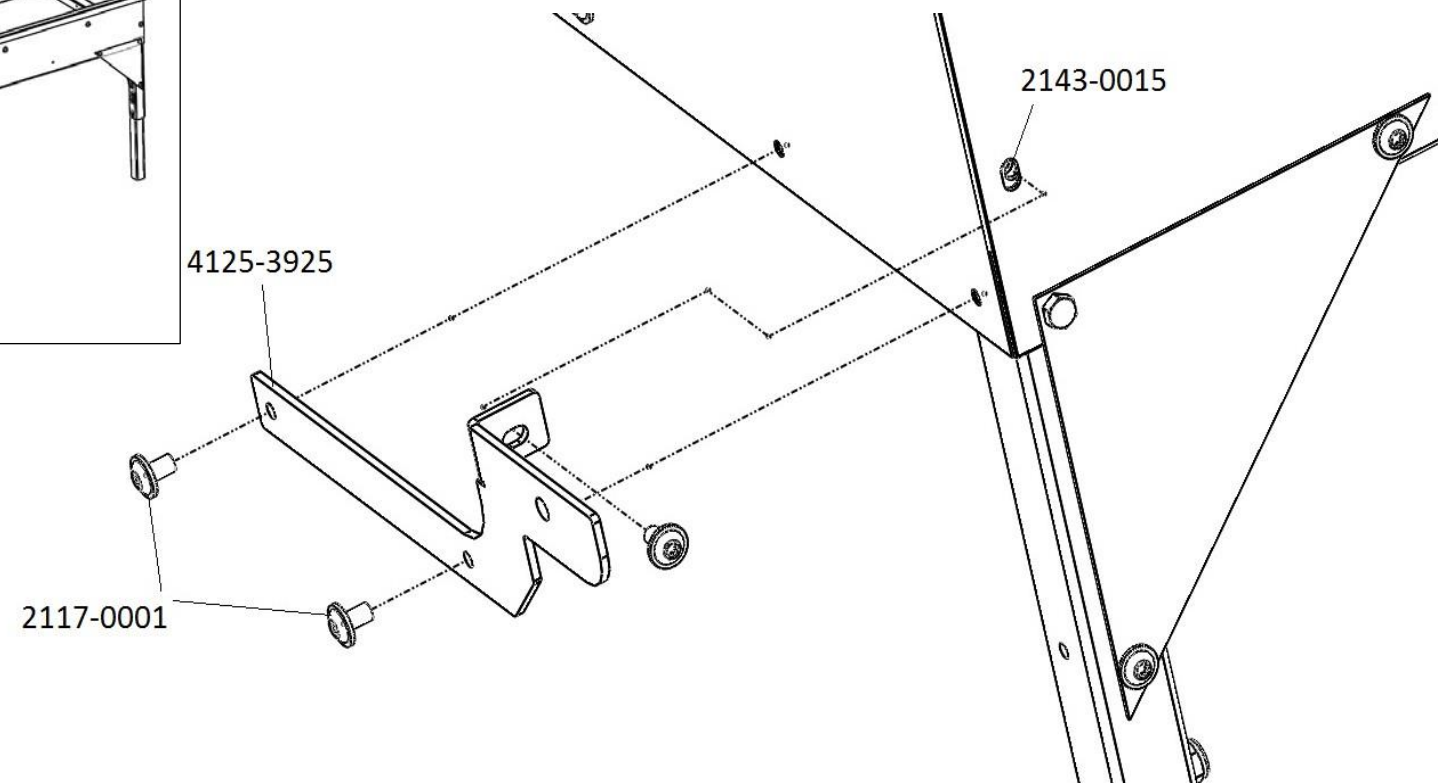
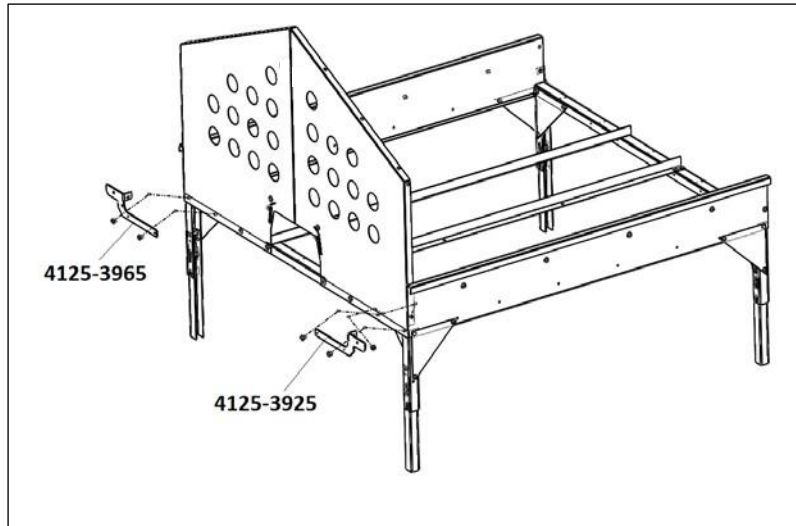

## 5.3

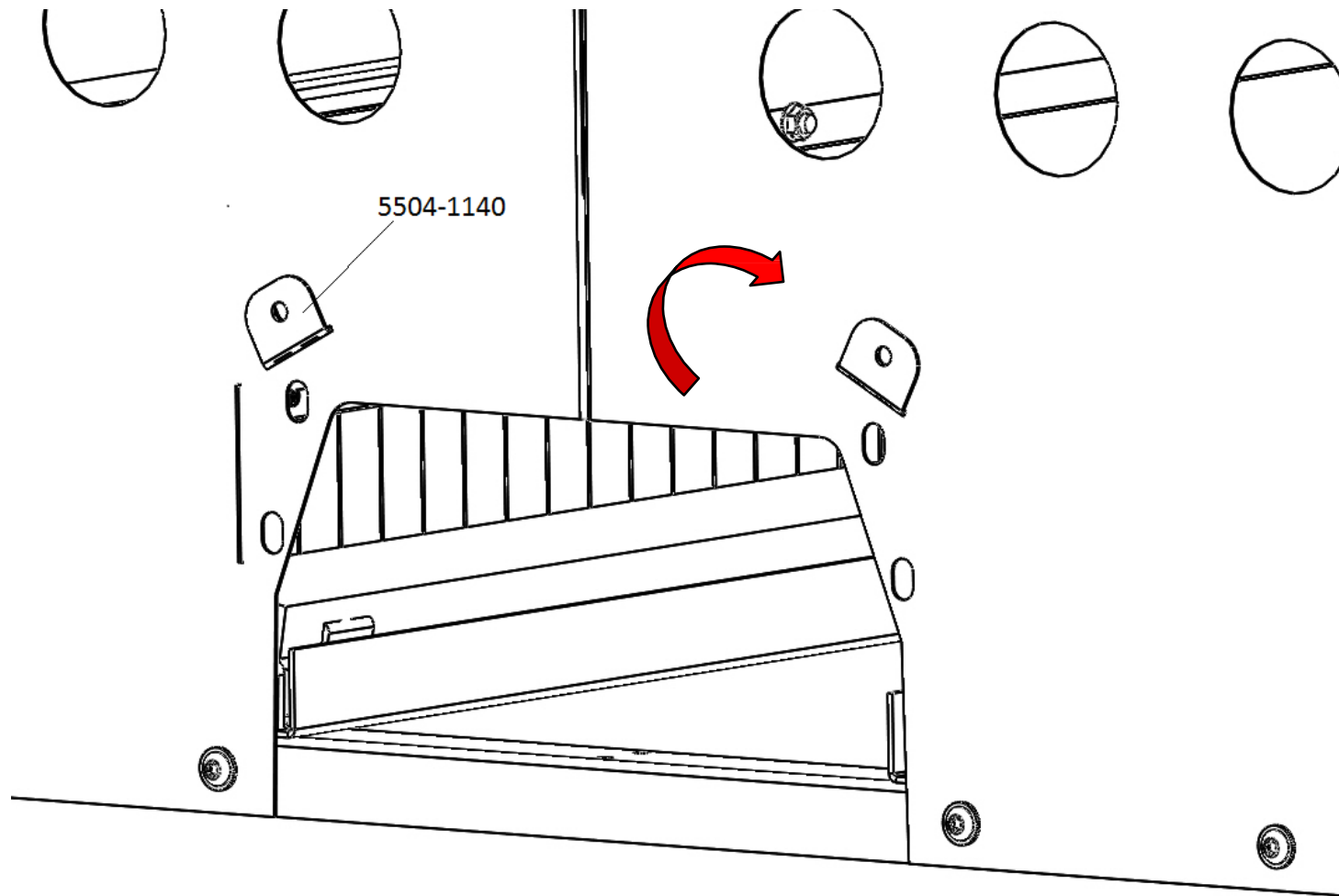

## 5.4

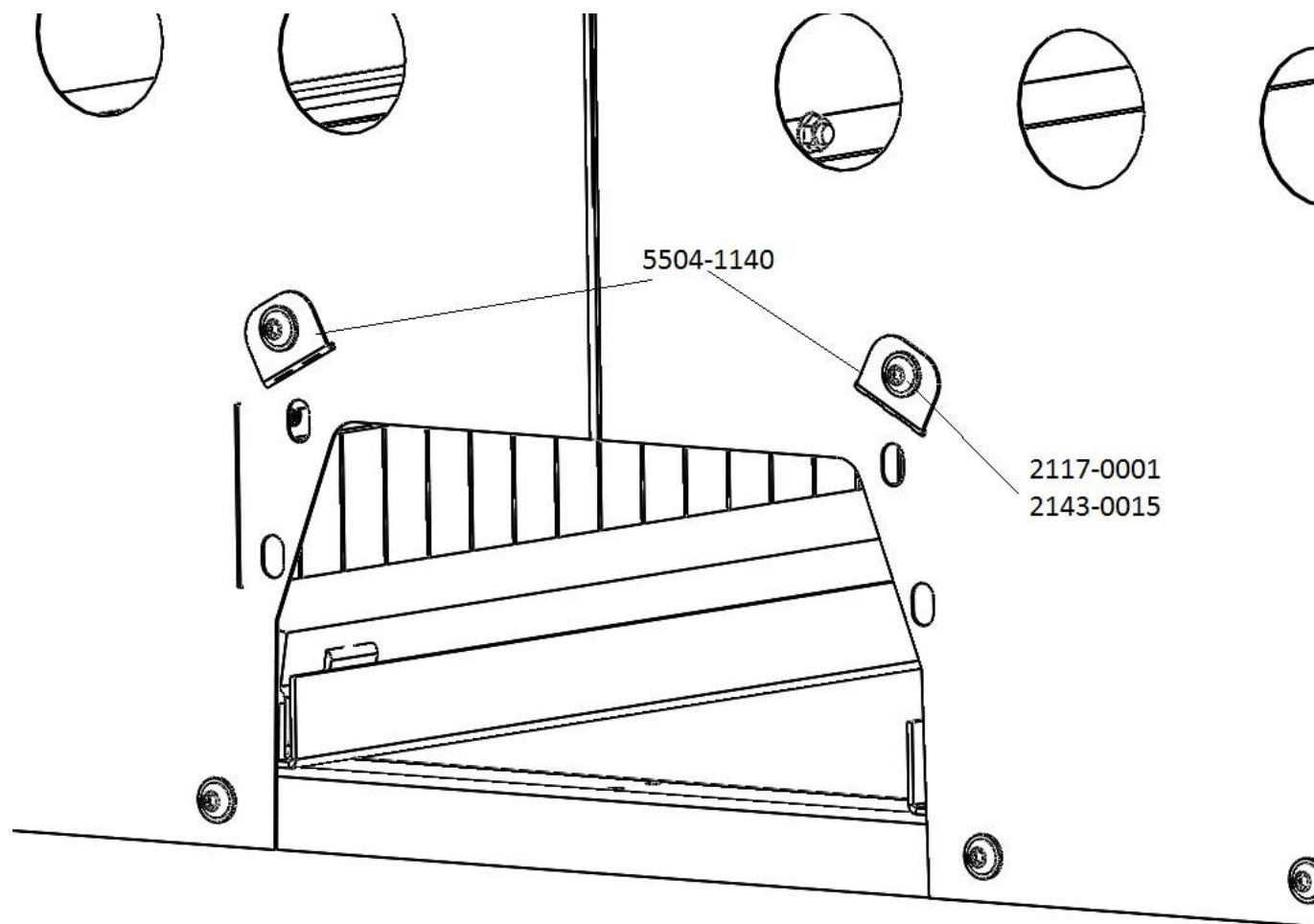

# INDIV<sup>®</sup>

## 5.5

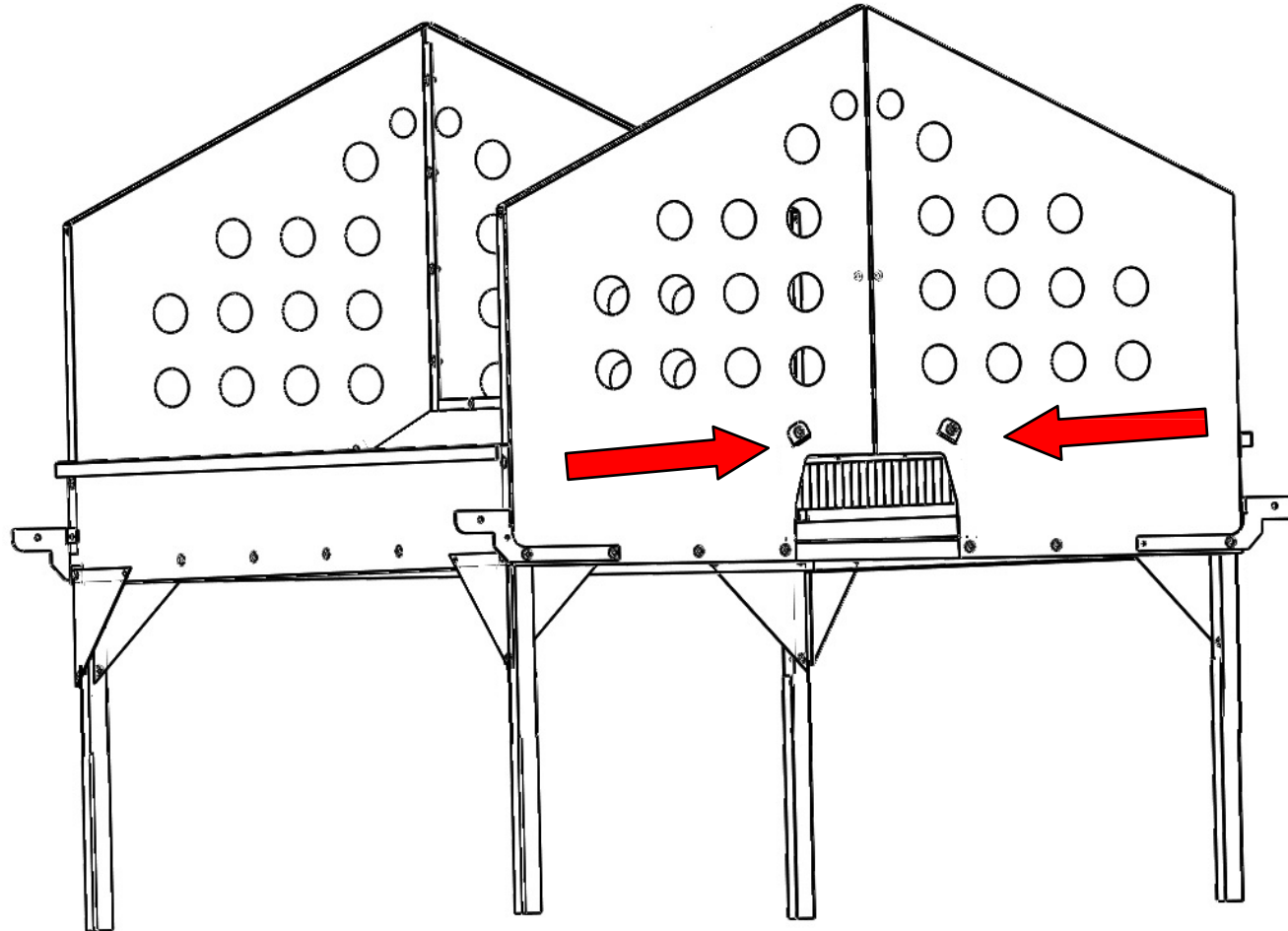

## 5.6

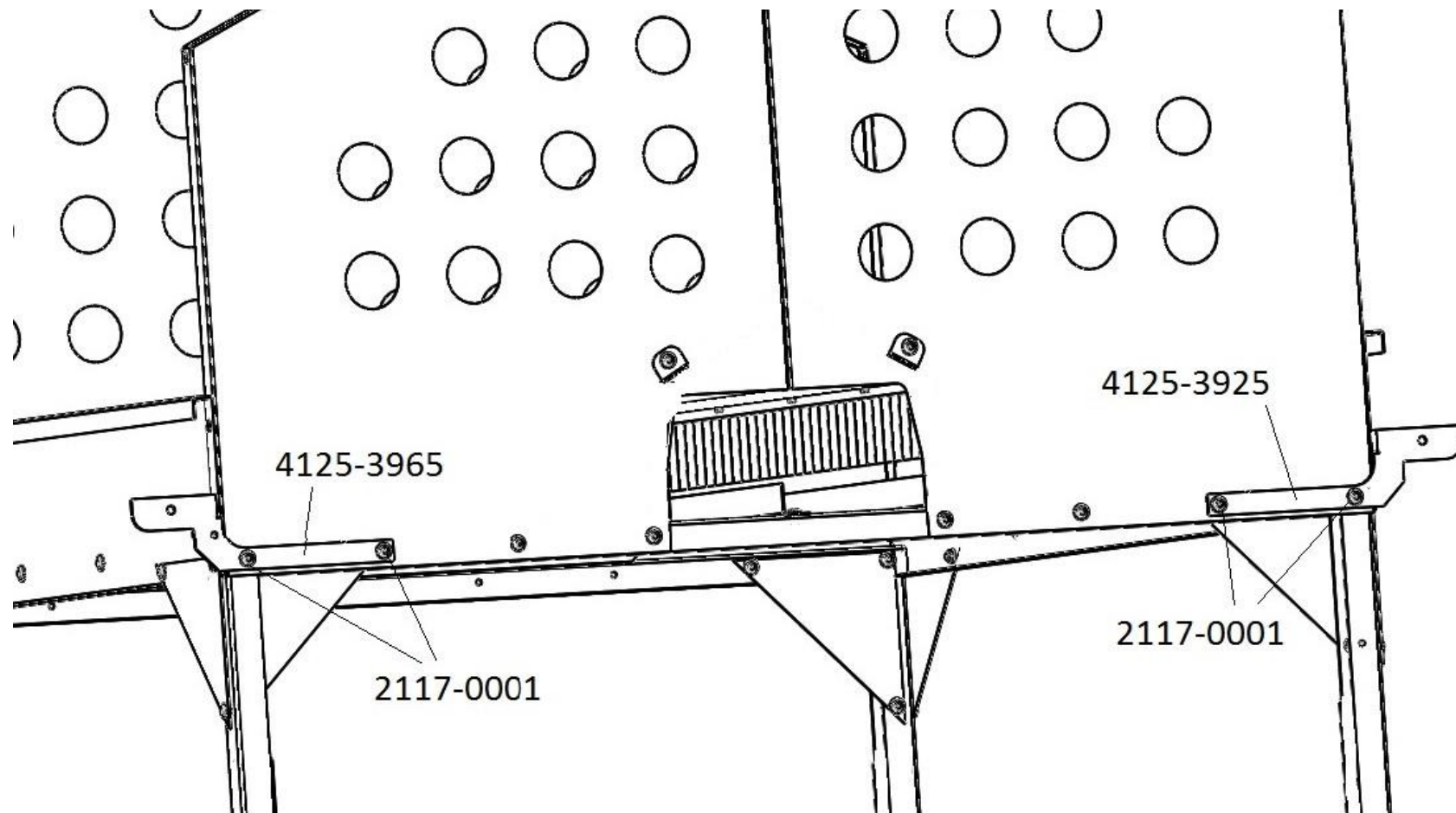



**INDIV**

**5.7**

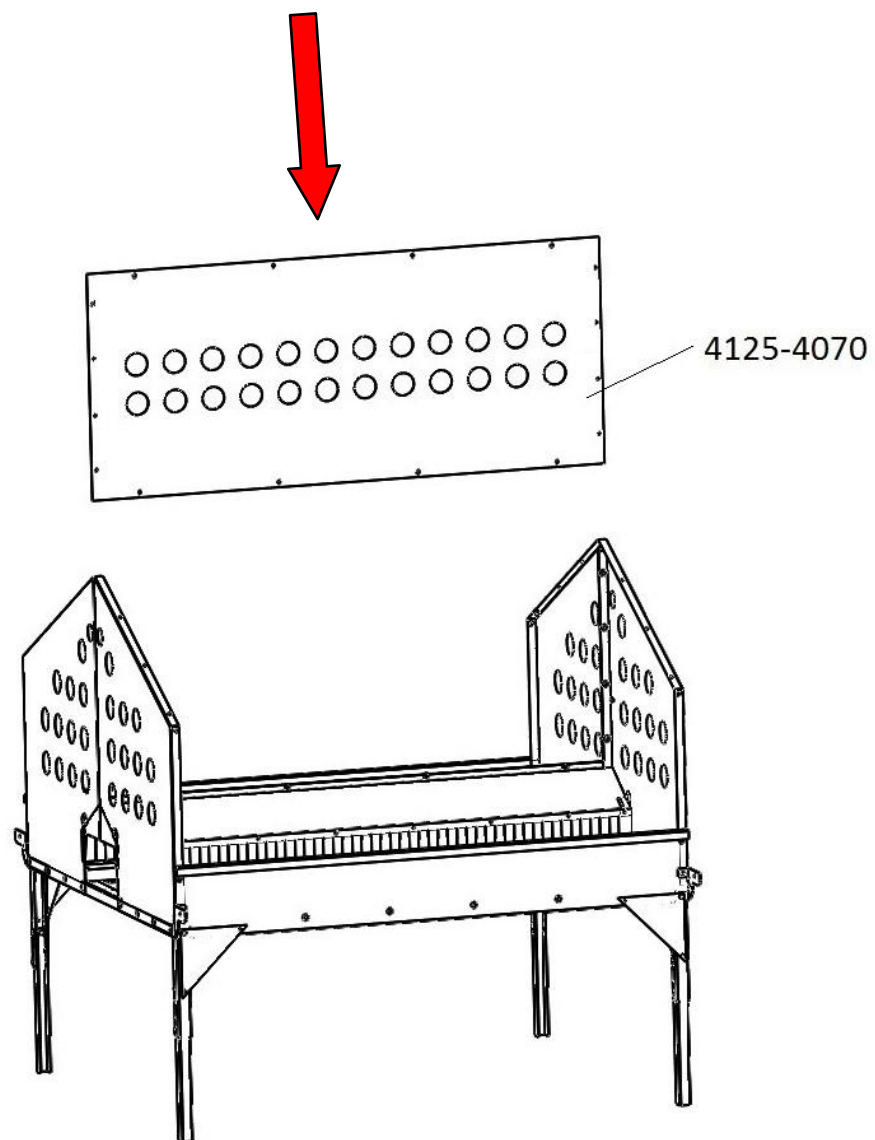

6.1  
5.8

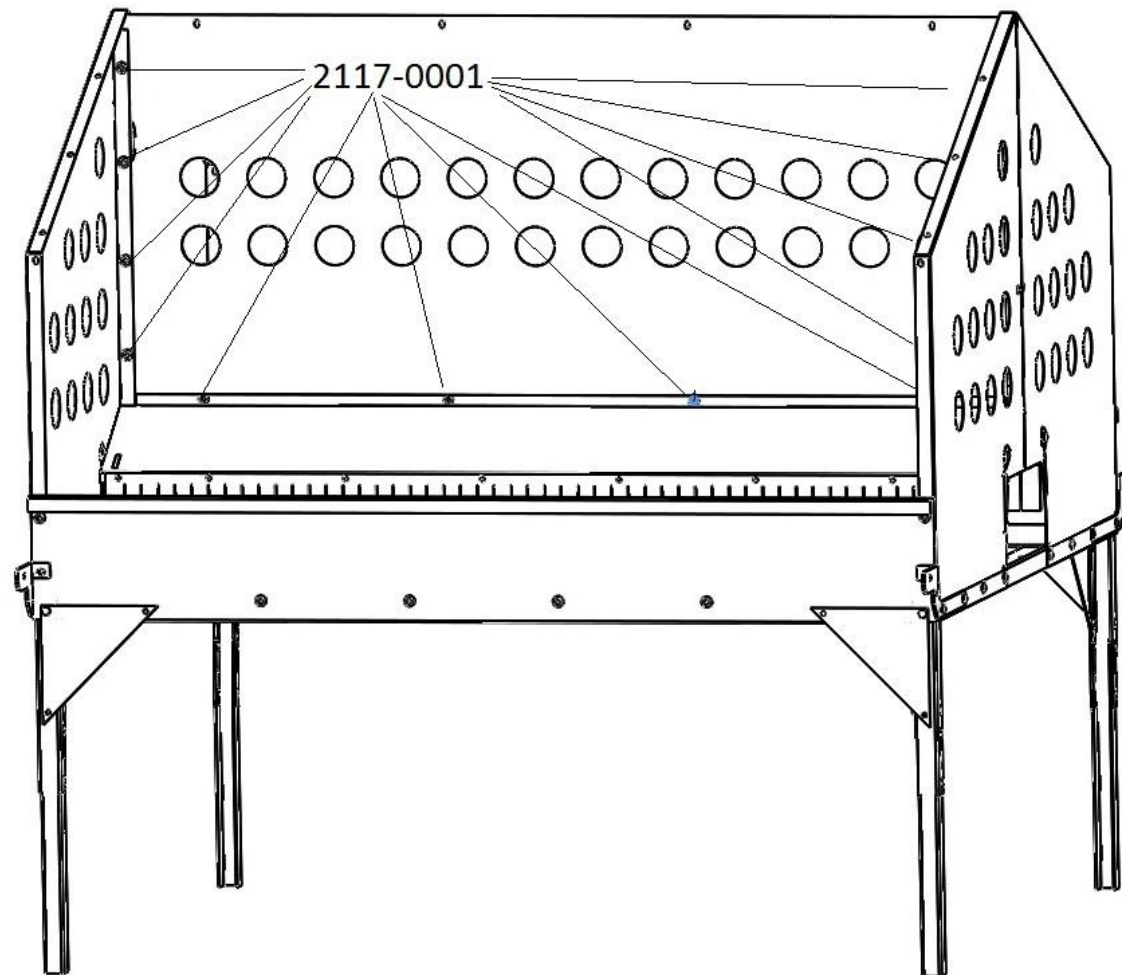

## 6.1

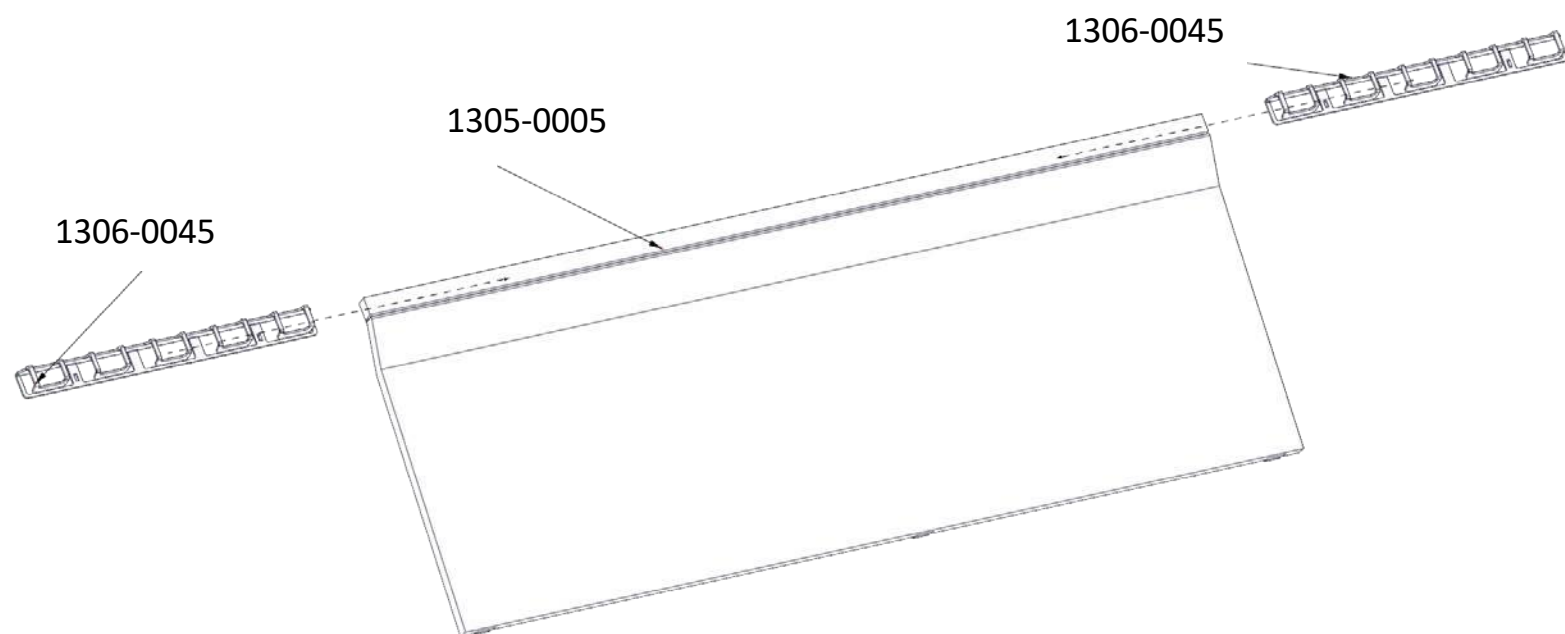

## 6.2

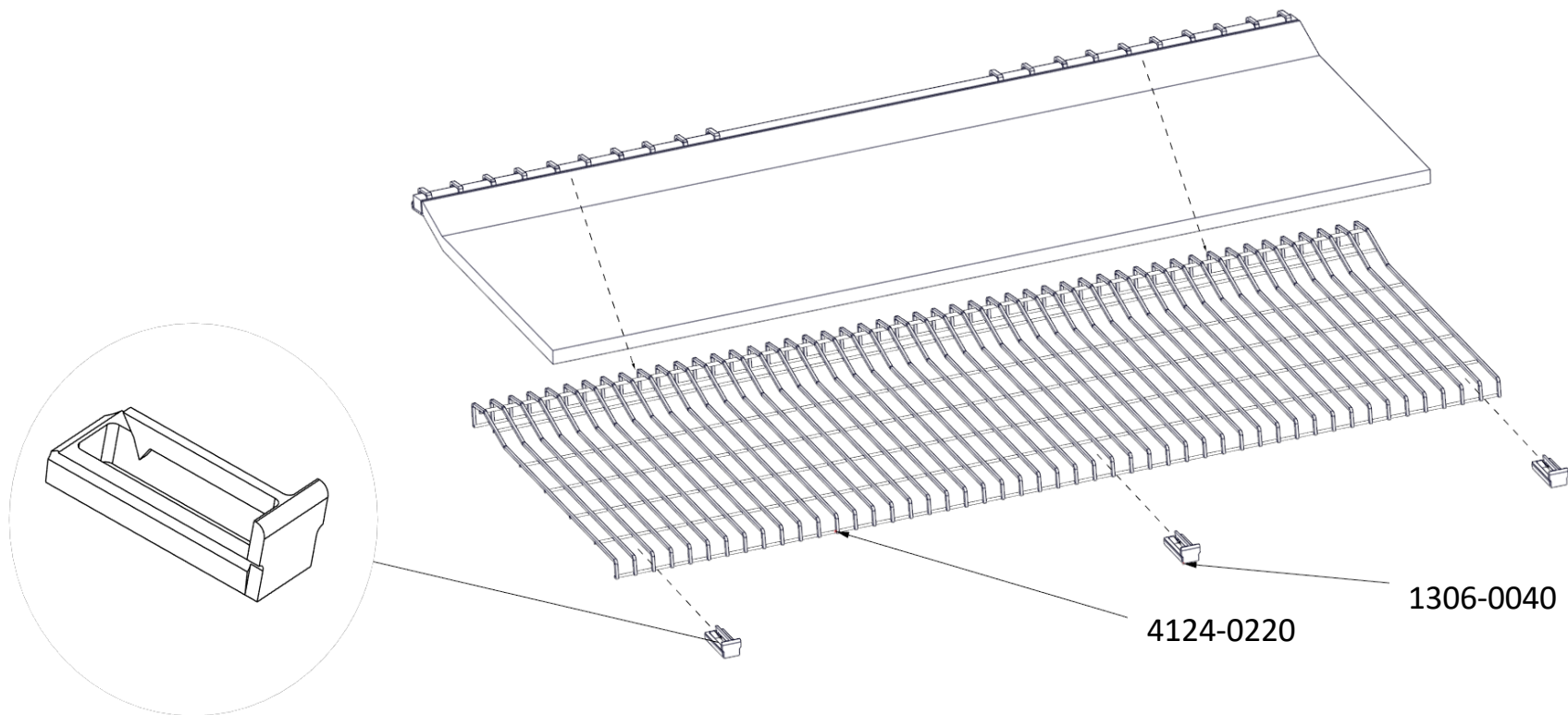

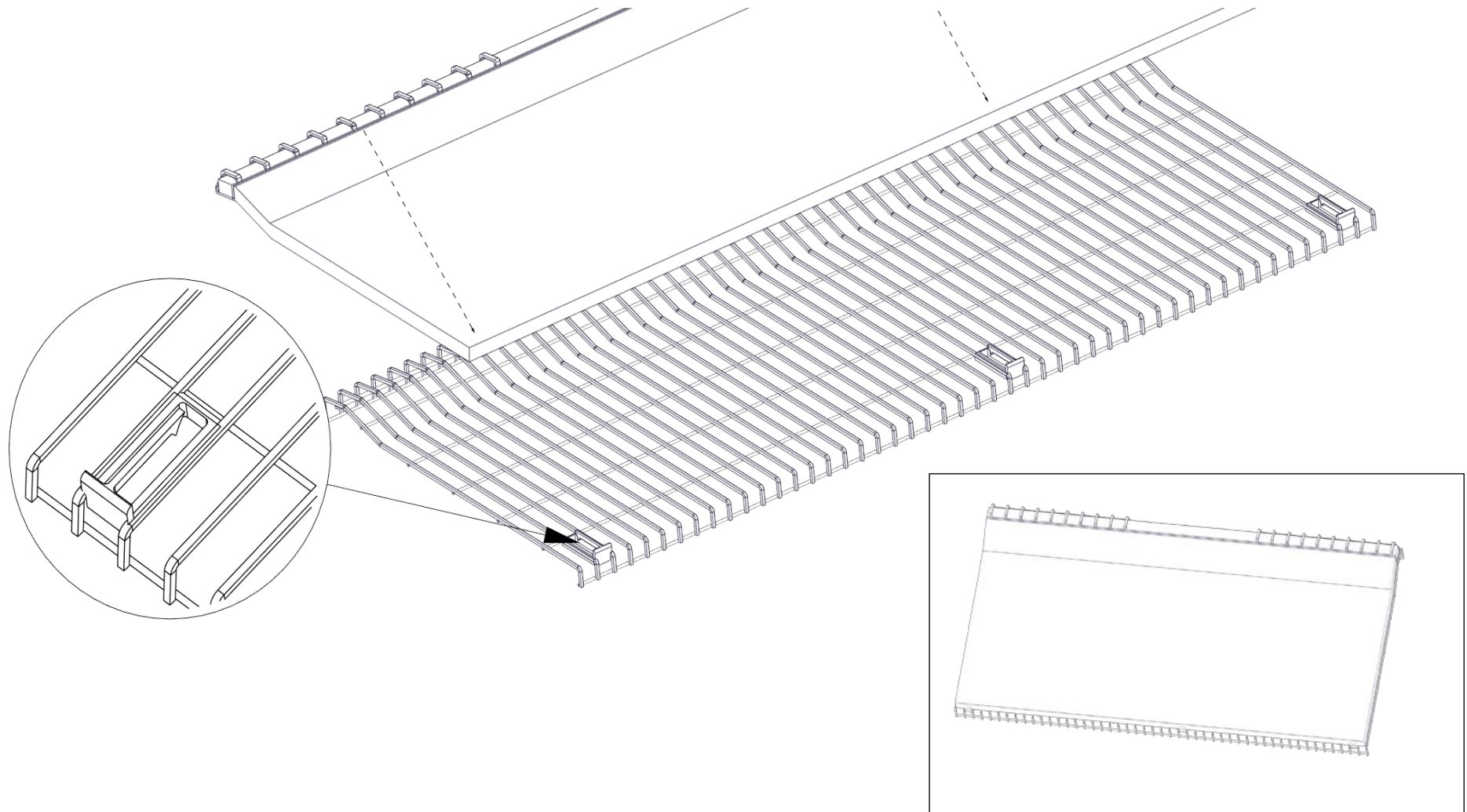

## 6.4

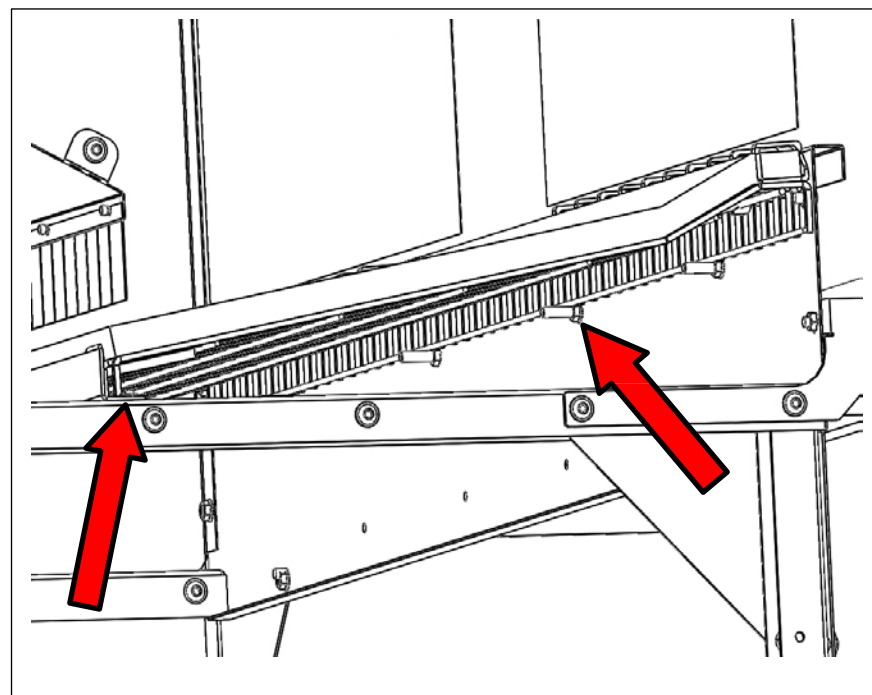
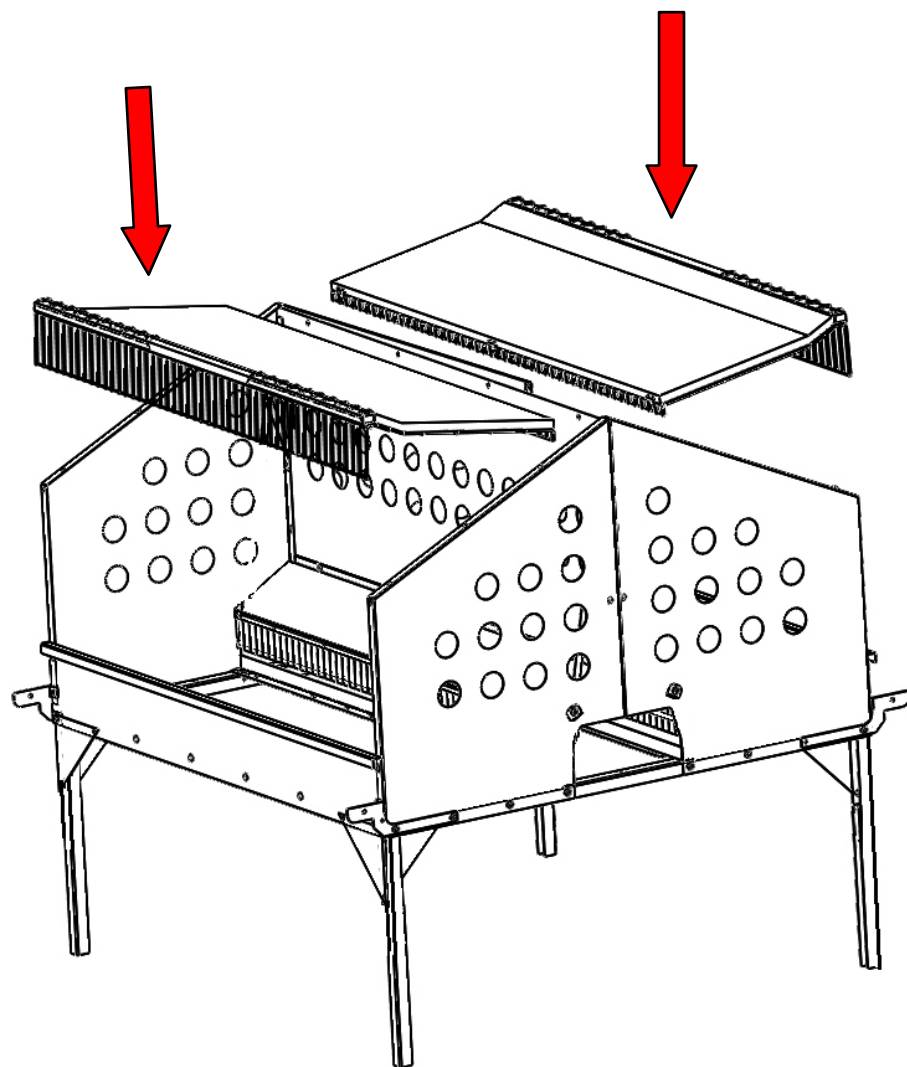



## 7.1

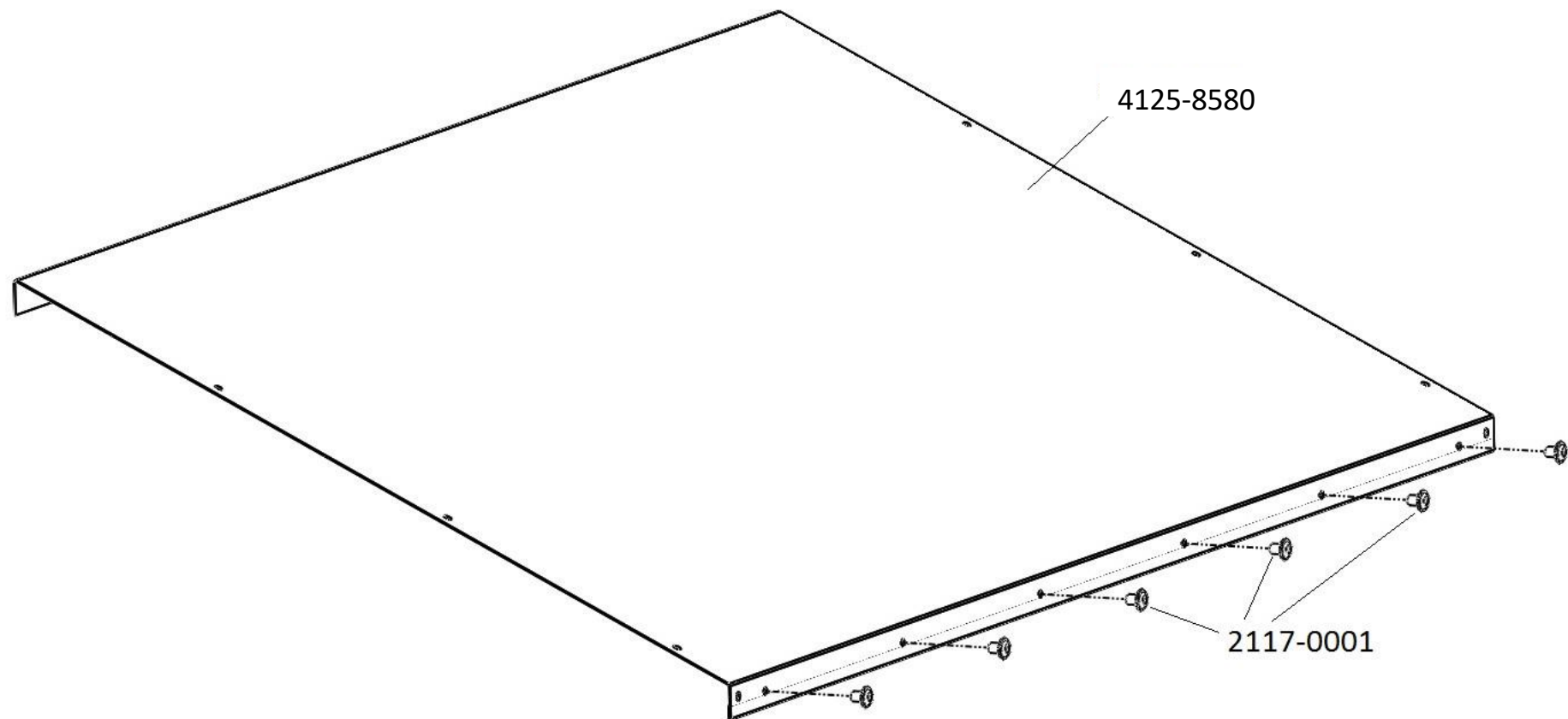

## 7.2

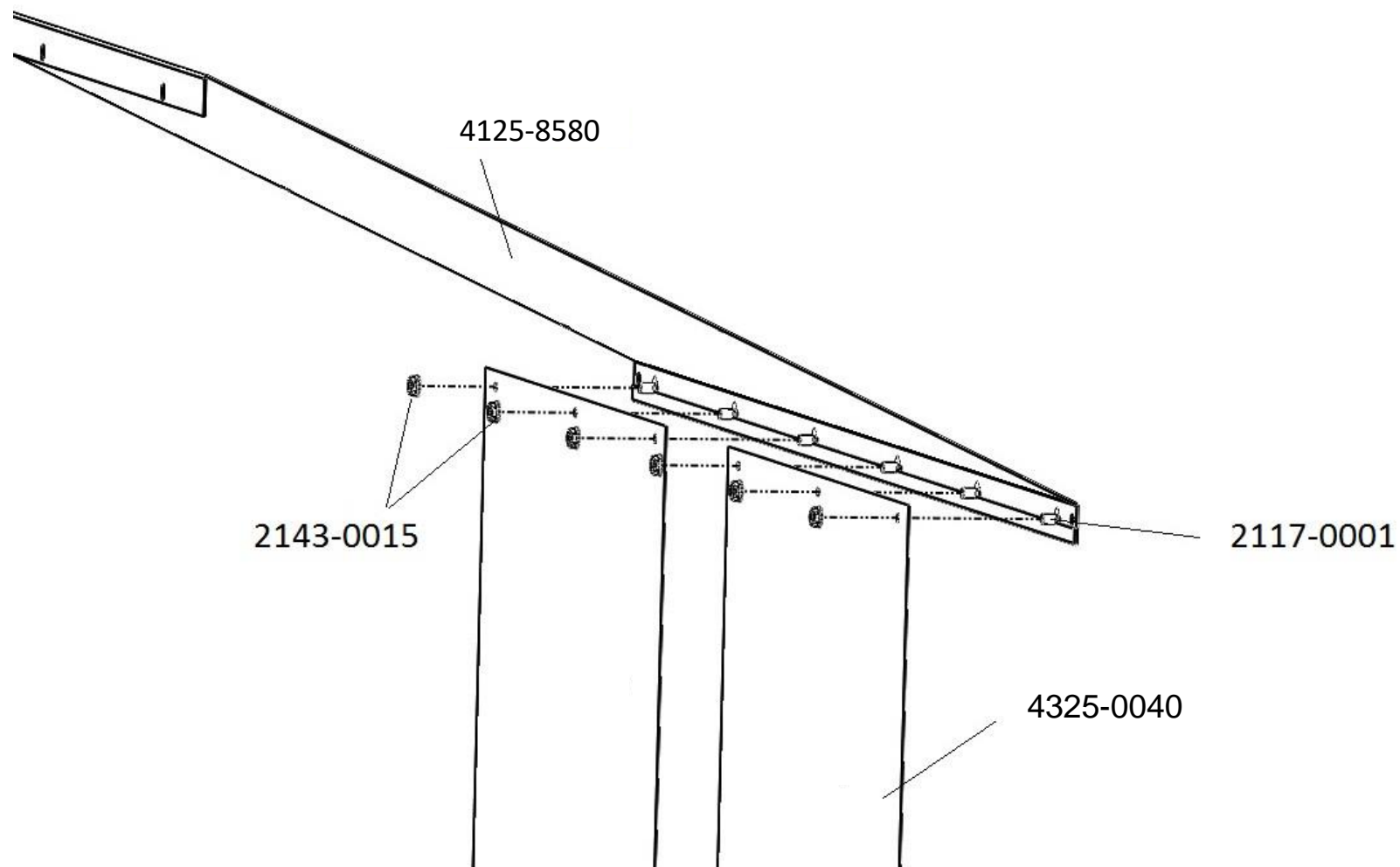

## 7.3

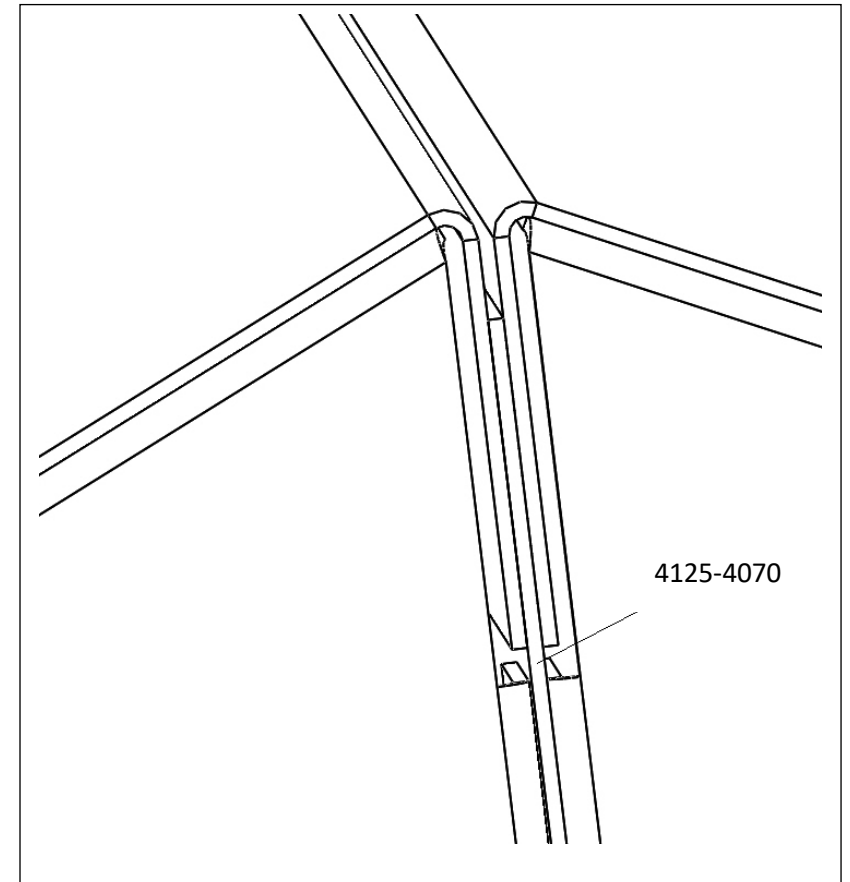
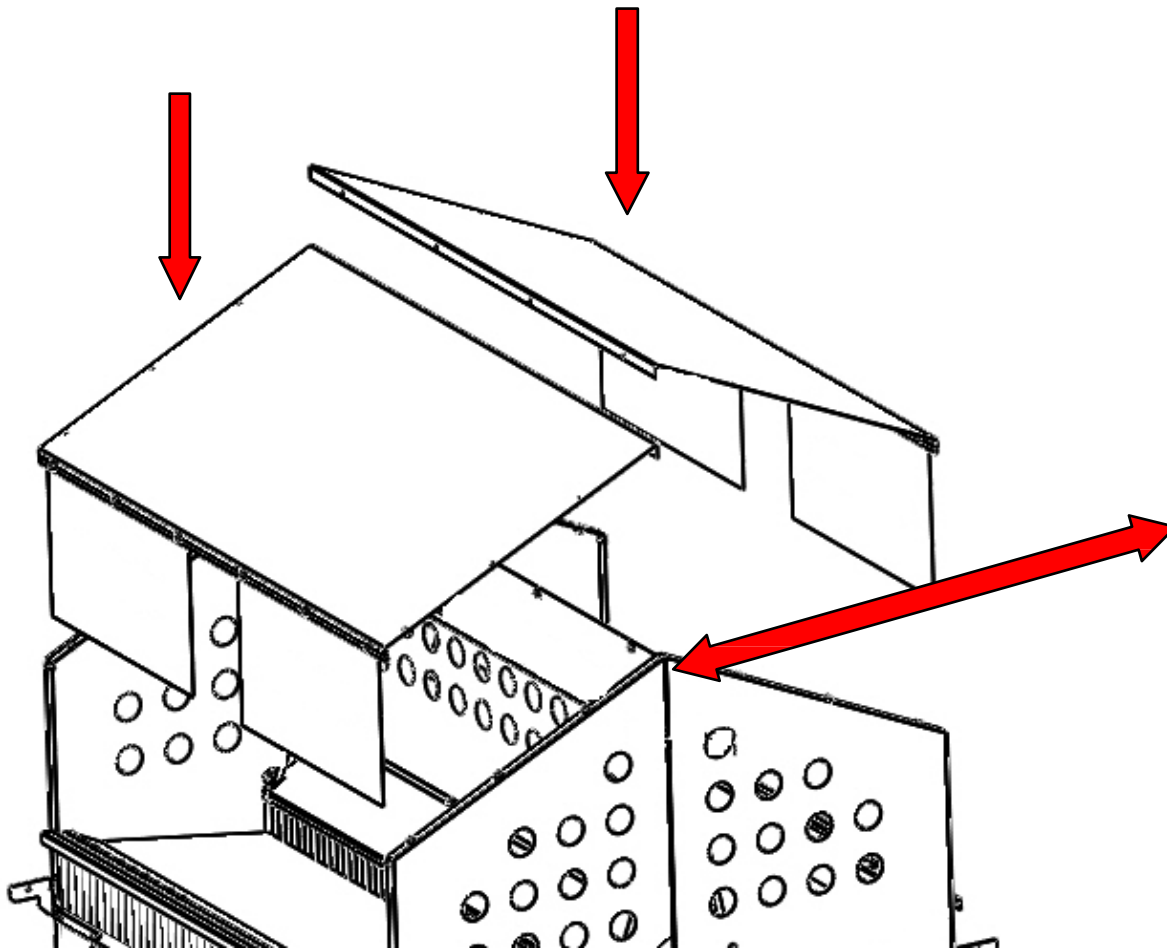

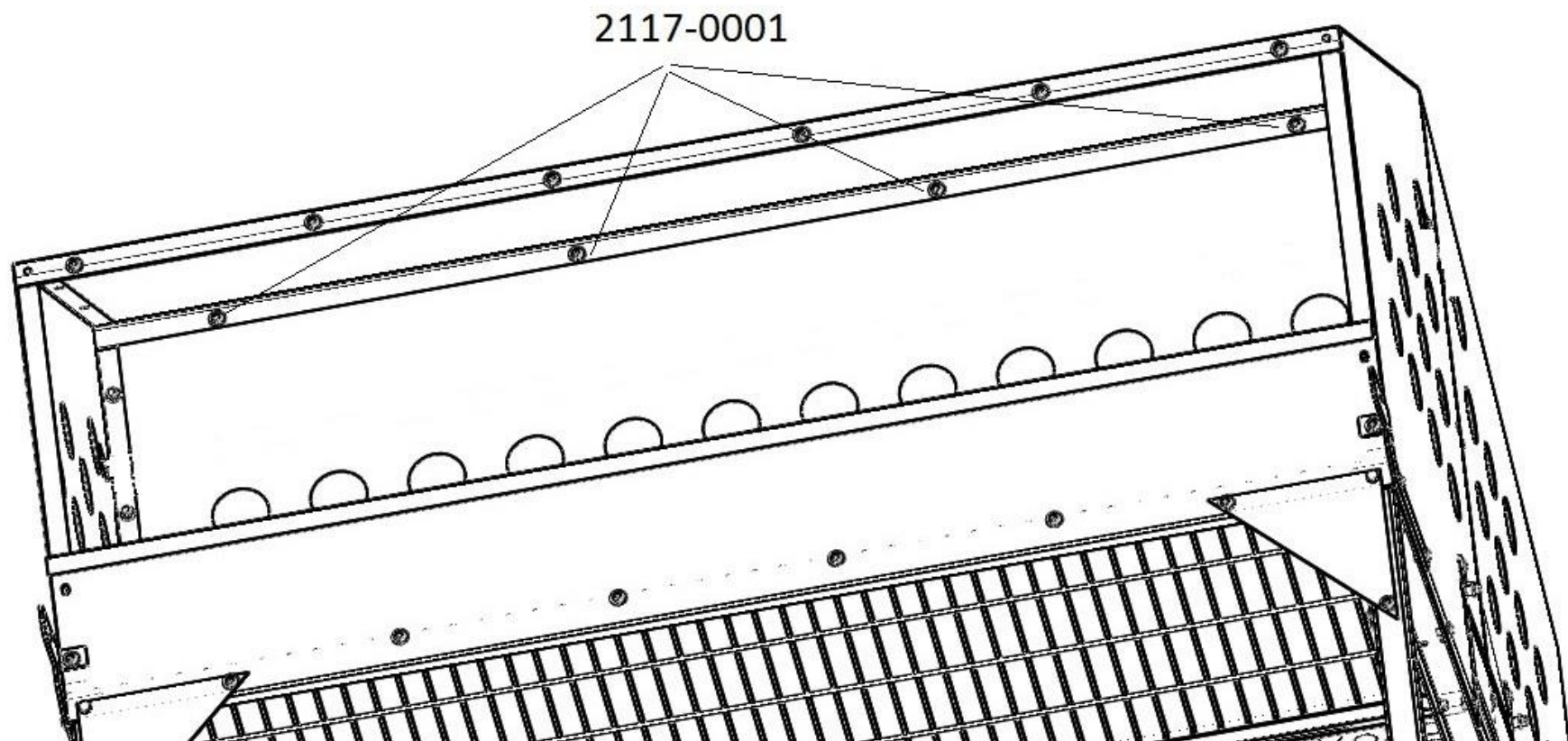

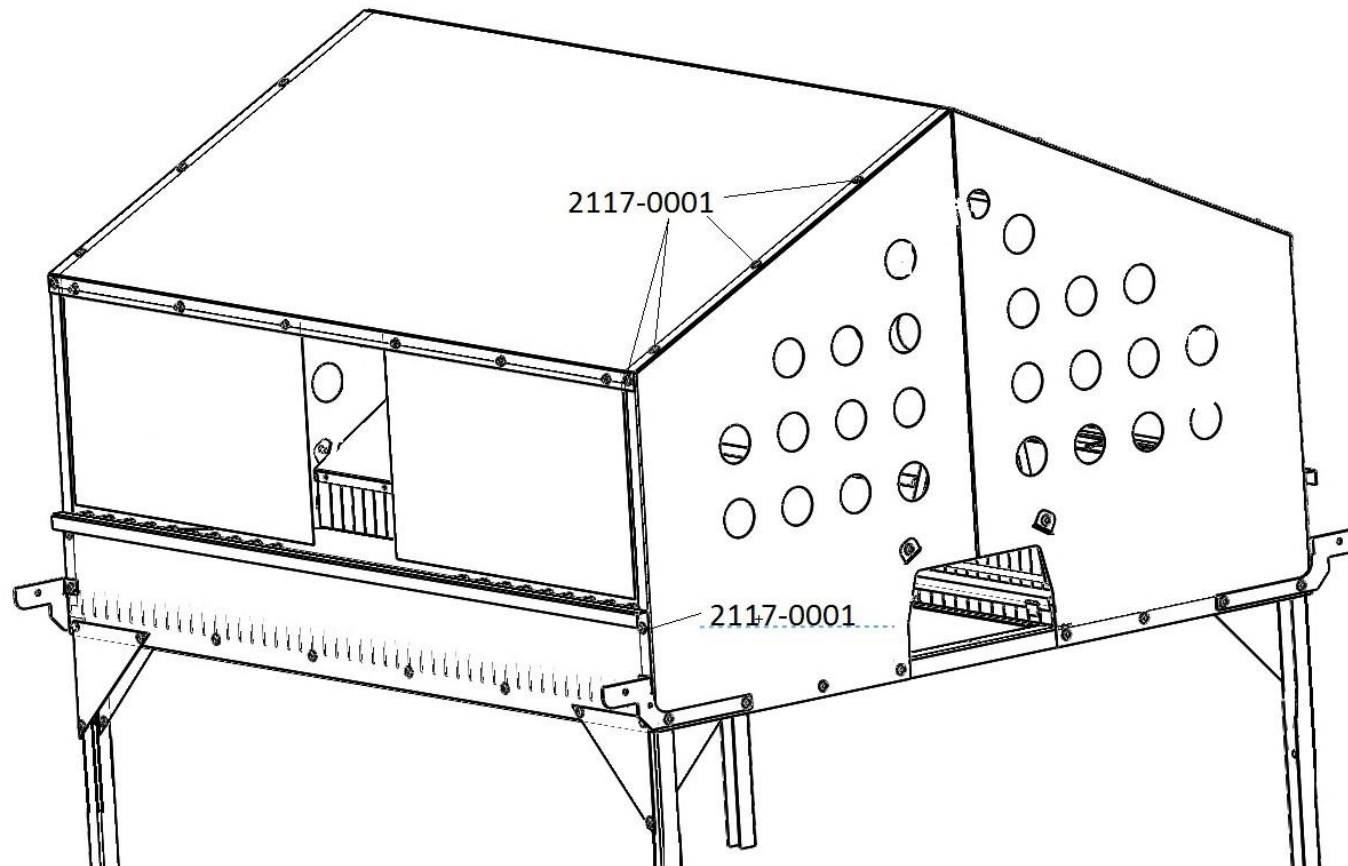

## 8.1

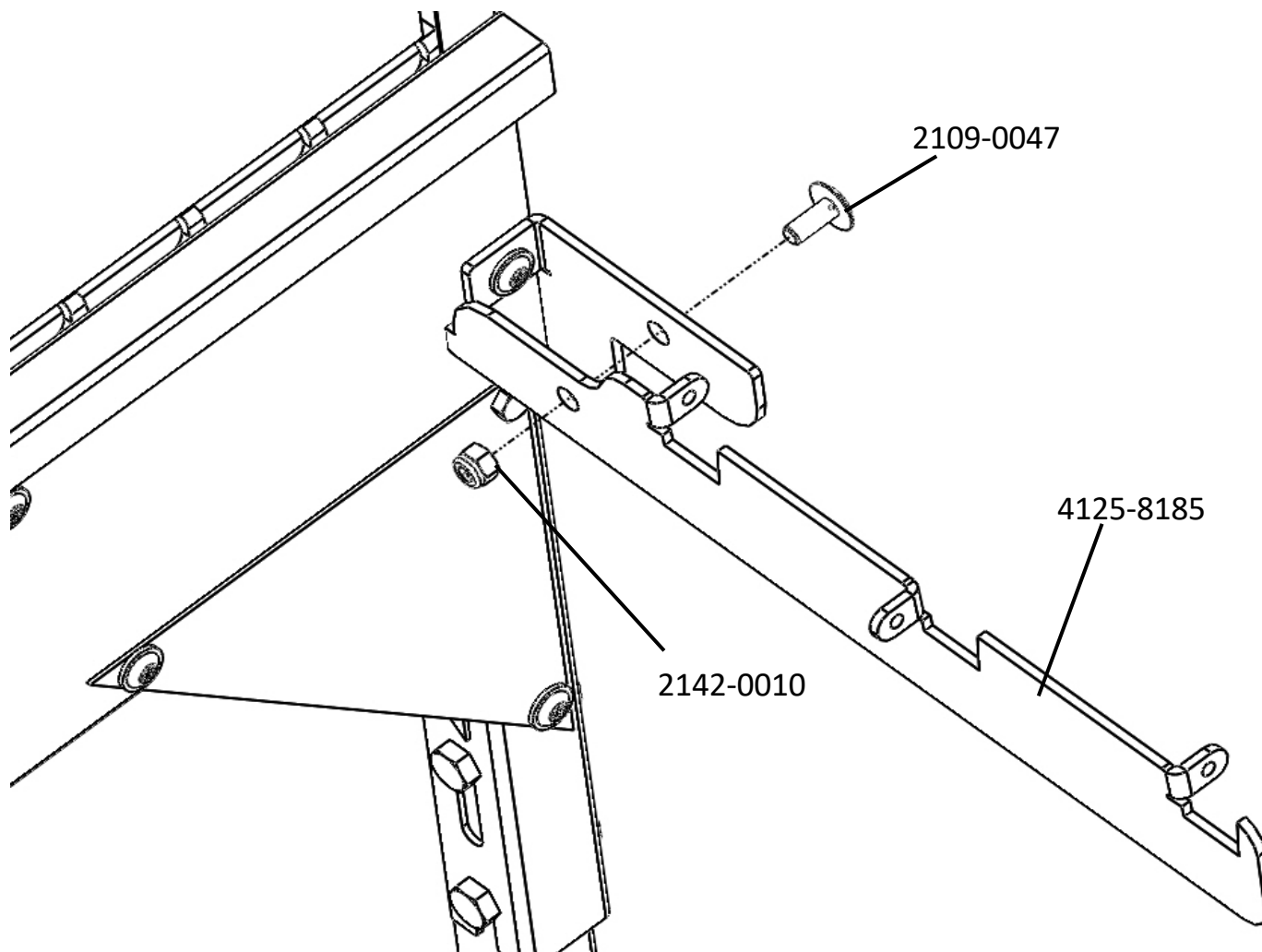



## 8.2

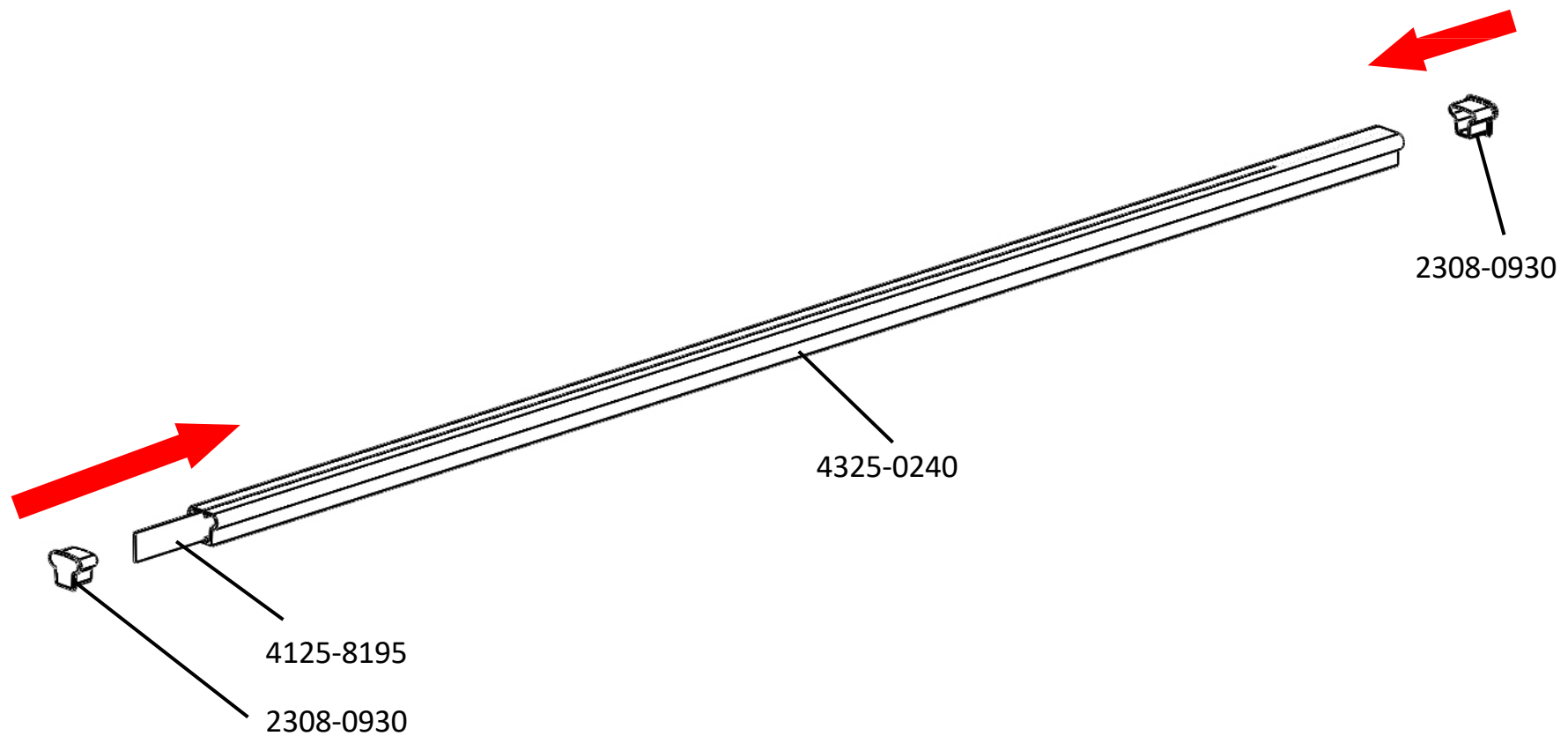

## 8.3

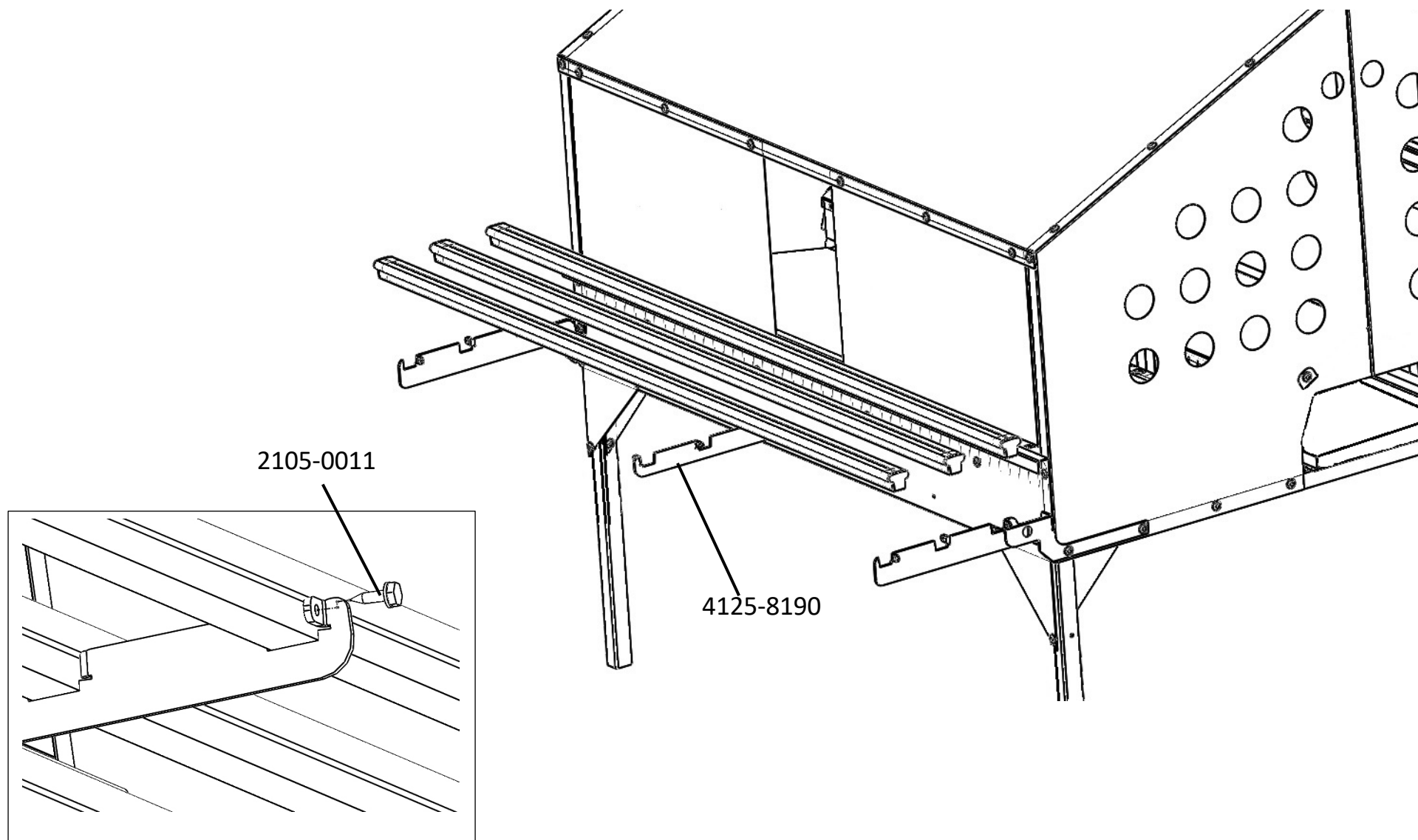

## 9.1

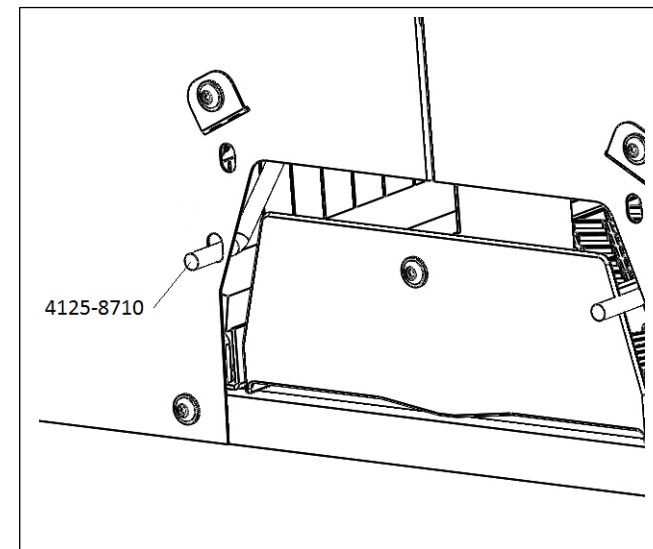
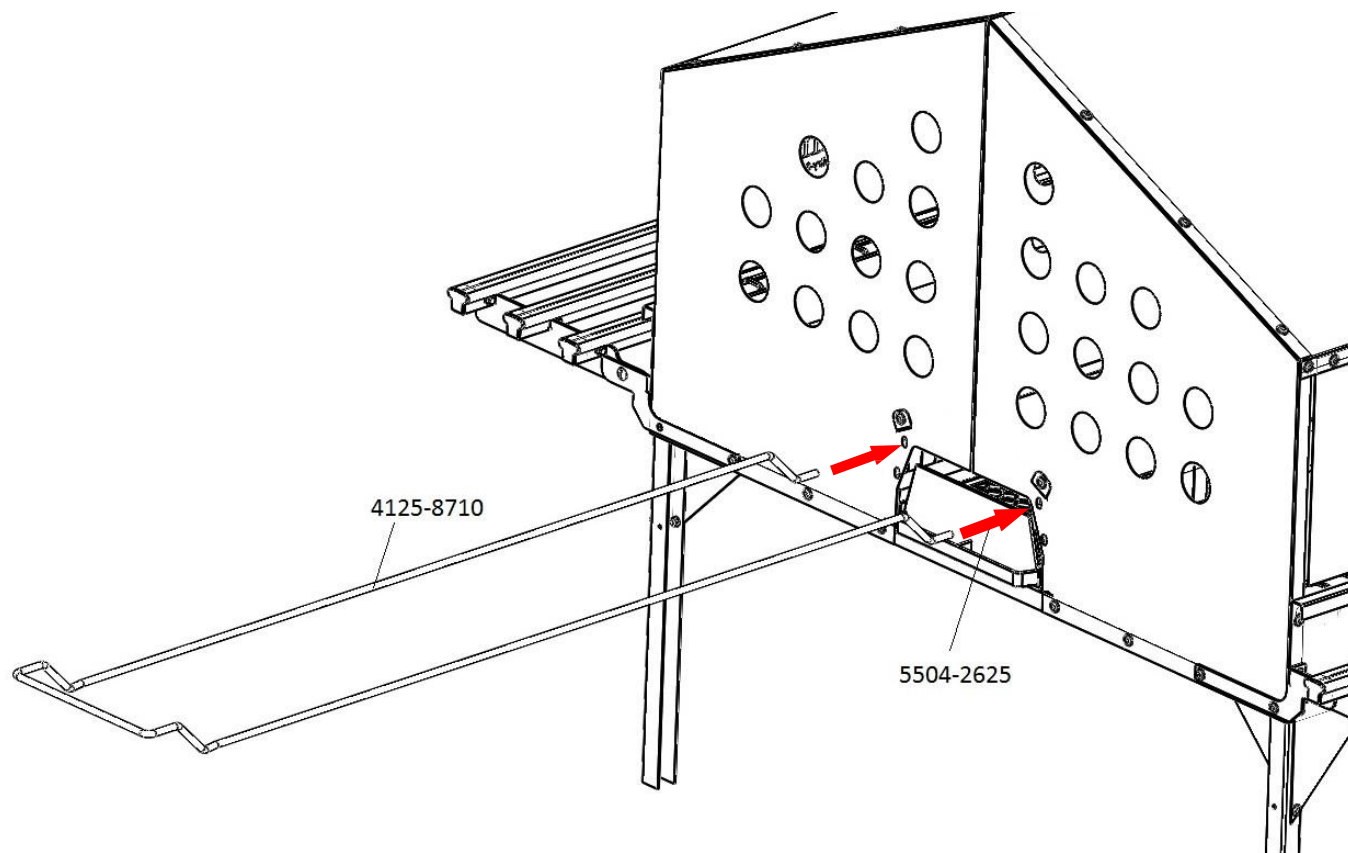

## 9.2

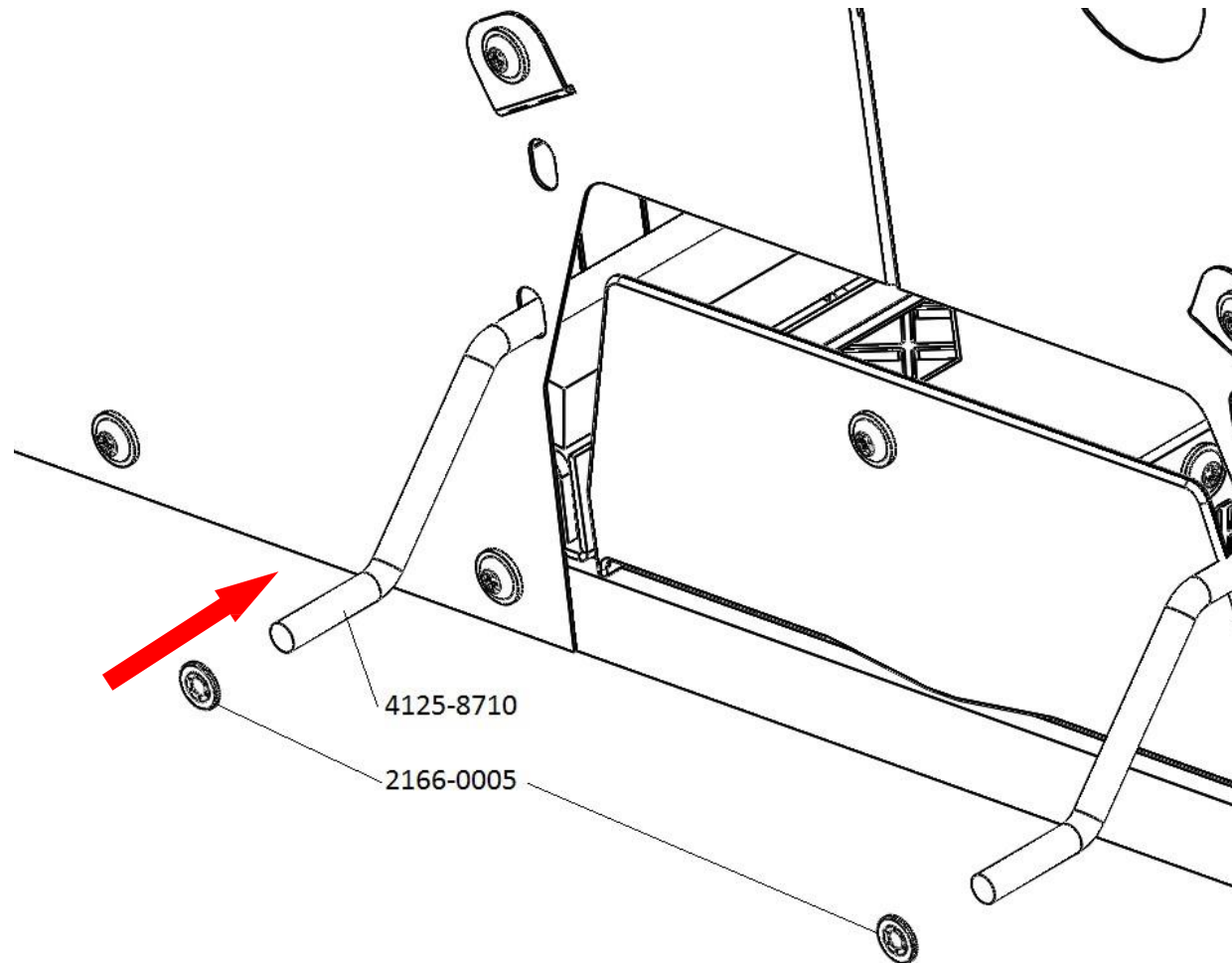

# NOTES